

Onderdelen

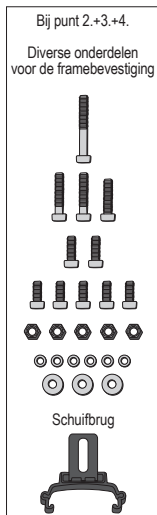

OPGELET!
15 mm minimum afstand tussen profiel en band aanhouden.

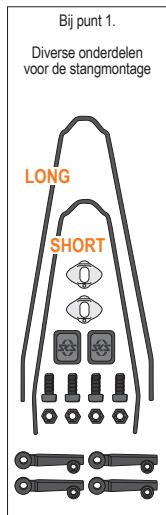
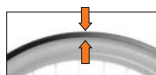

1. Stangmontage voor + achter

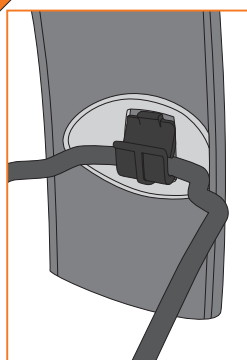
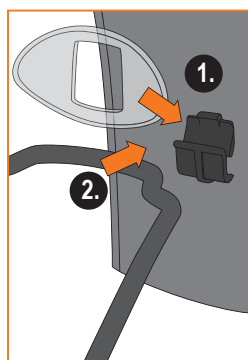
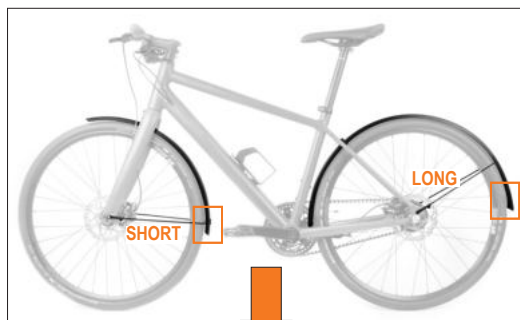
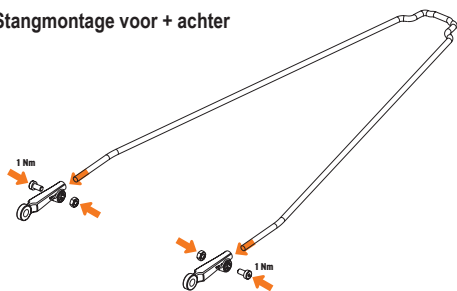

2. Framebevestiging voor

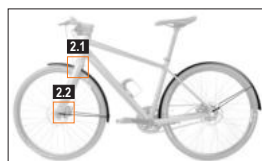

2.2 Stangbevestiging voor incl. lengte-instelling van de stangen.

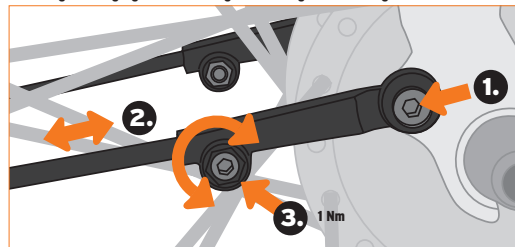

3. Framebevestiging achter

3.1 Achterwiel demonteren

3.2 Bevestiging van de schuifbrug bij 90° hoek

3.2.1 Schuifbrug vastschroeven

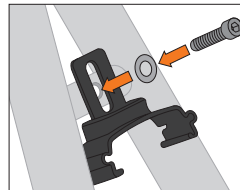

3.2.2 Spatbord erop klikken

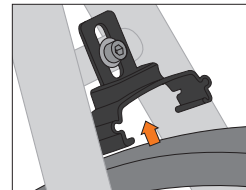

3.3 Bevestiging van de schuifbrug bij 0° hoek

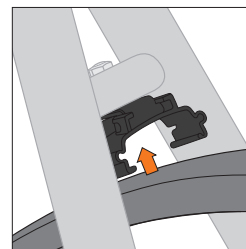
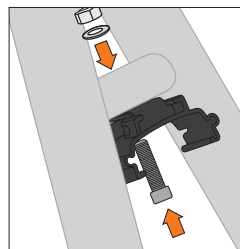

4. Trapaslagermontage

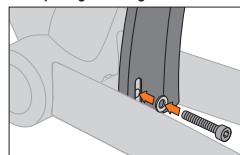

5. Achterwiel weer monteren

6. Stangmontage achter

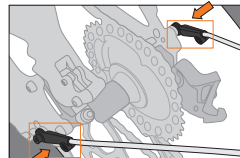

6.1 Stangbevestiging achter incl. lengte-instelling van de stangen

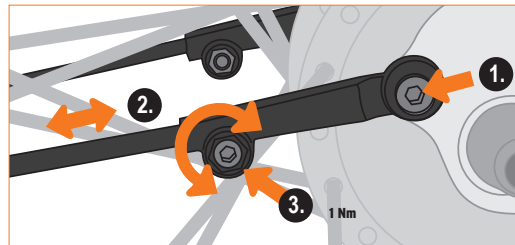

OPGELET! Afstandsringsmontage voor frames met schijfremmen

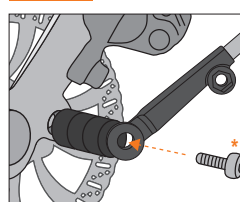

* Schroef niet bij de levering inbegrepen