

FRONT

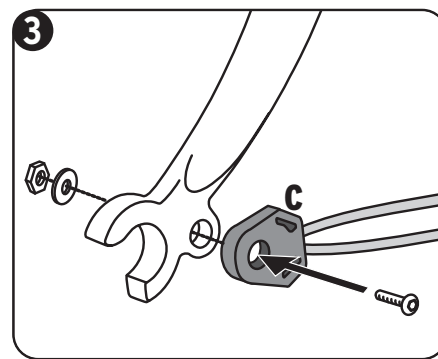

REAR

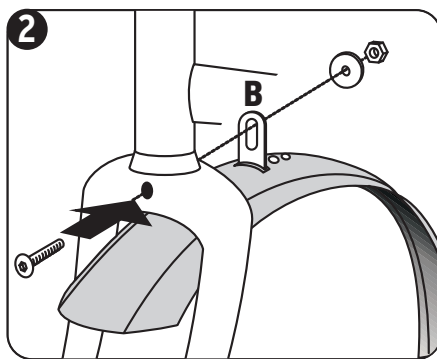
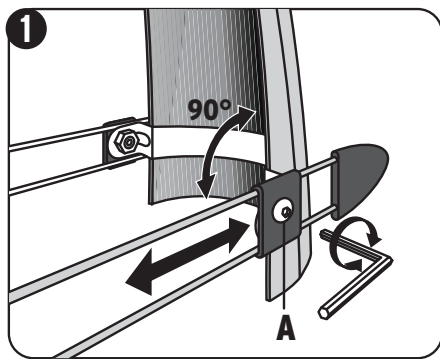
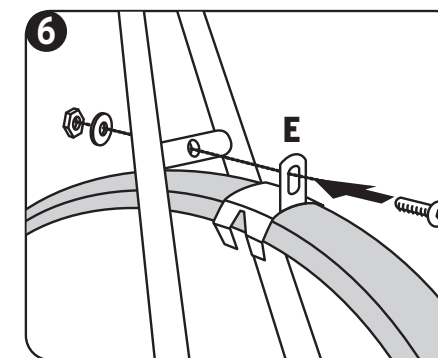
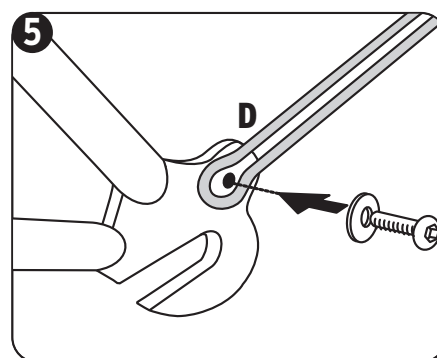
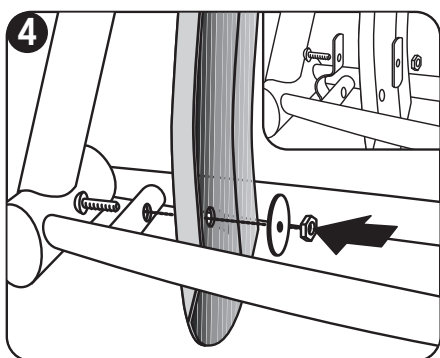

ASSEMBLY INSTRUCTIONS

FRONT

1. Untighten the screw **A** and turn the double stay up to a 90 degree to the profile.
2. Attach the front mudguard with the bracket **B** at the fork crown (suspension fork at the fork arch).
Choose the right screw length to attach it from the front or from the rear. Use the fixation points of reflector or brake.
3. Attach the double stay with SECUCLIP **C** from the outside of the fork at the eyelets.

⚠ ATTENTION: The attachment screws should not touch the spokes or the hub! Adjust the distance between mudguard and tire to get 1,5 cm clearance (pic.1). Tighten all screws with care and check them all.

REAR

4. If it is not possible to use the enclosed clip, screw the front end of the mudguard on the chainstay bridge.
5. Attach the front end of the rear mudguard to the frame. (pic. 4) Attach the ends of the double stays **D** (pic. 5) with the screws at the dropout eyelets.

⚠ ATTENTION: The screws should not touch hub, sprocket or chain!

6. Attach the sliding bridge **E** on the brake stay with the right screw. **DO NOT CRUSH THE EDGES OF THE SLIDING BRIDGE ONTO THE GUARD.** Use the fixation points of the reflector or brake. If the hole is underneath, you have to punch a hole in the mudguard and screw directly into the brake bridge.

⚠ ATTENTION: Please ensure an even clearance between mudguard and tyre.