

INITIAL ASSEMBLY



A: \varnothing 15-19 mm

B: \varnothing 19-23 mm

C: \varnothing 23-27 mm

D: \varnothing 27-31 mm

E: \varnothing 31-35 mm

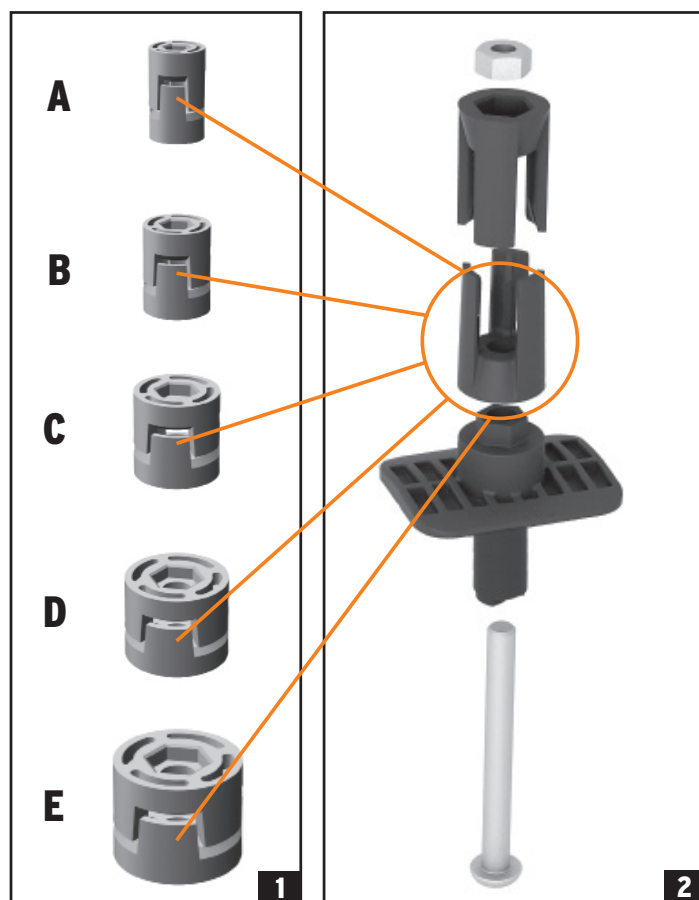

LIEFERUMFANG · SUPPLIED WITH:

Konus · cone diameter 1 → 15 - 19 mm

Konus · cone diameter 2 → 19 - 23 mm

Konus · cone diameter 3 → 23 - 27 mm

Konus · cone diameter 4 → 27 - 31 mm

Konus · cone diameter 5 → 31 - 35 mm

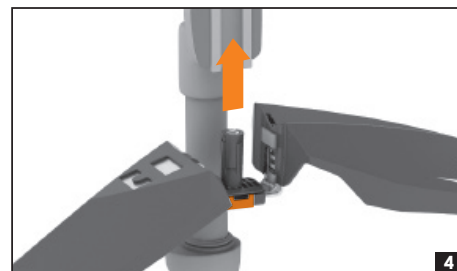
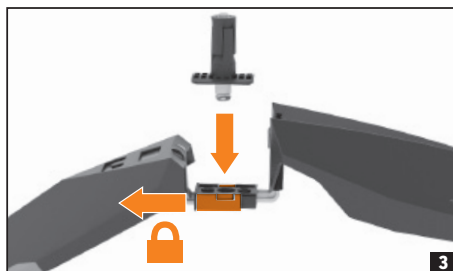
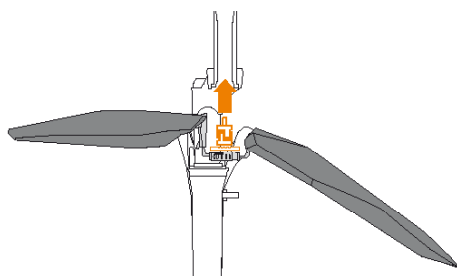

INFO GRAND D.A.D

Remove orange protection cap
before tightening screw.

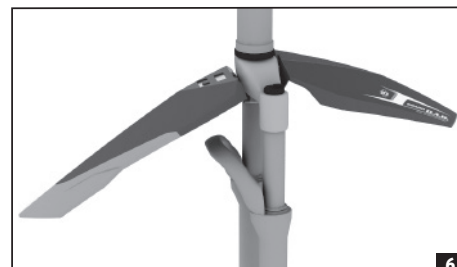
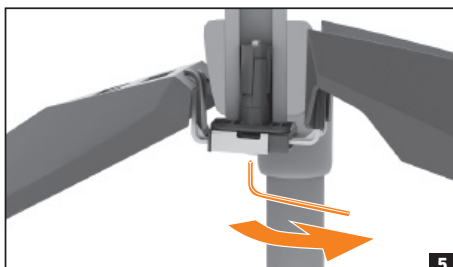

HORIZONTAL ADJUSTABILITY

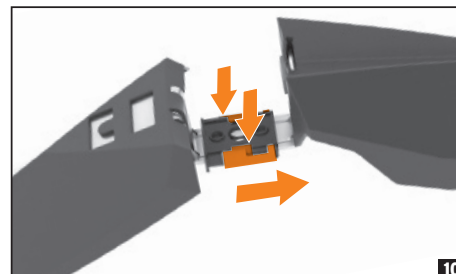
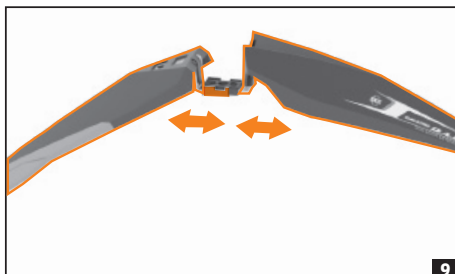
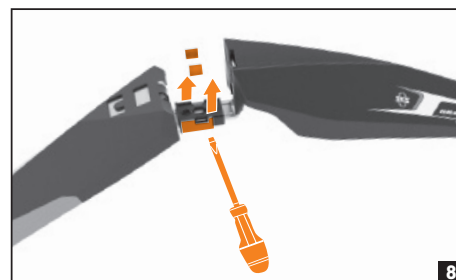
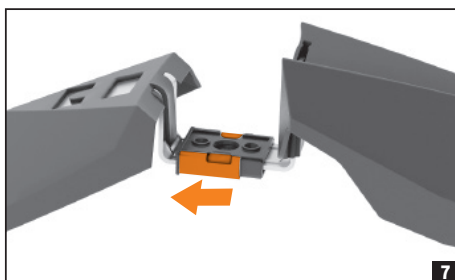
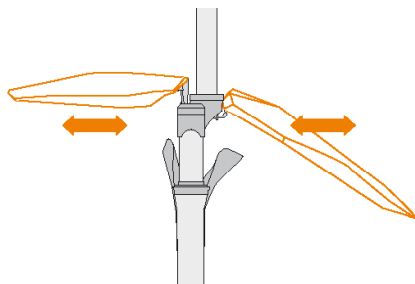

VERTICAL ADJUSTABILITY

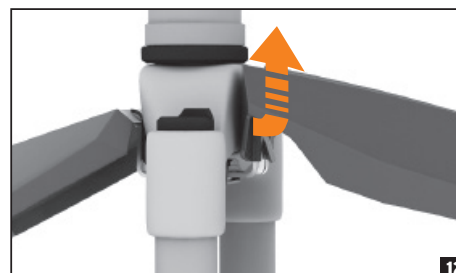
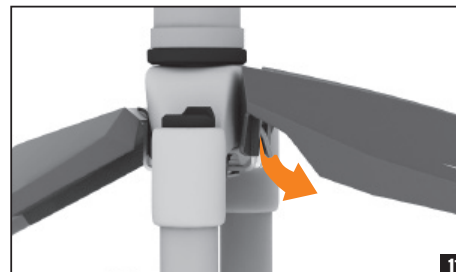
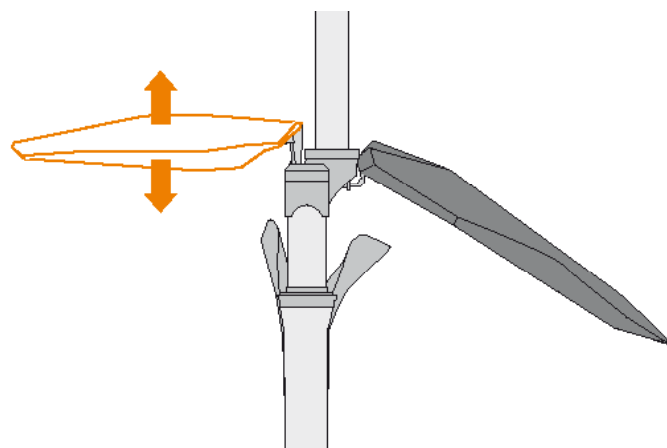

EN.MANUAL

The **GRAND D.A.D.** allows horizontal and vertical adjustment for all front suspension forks. For perfect and secure function please read the manual carefully.

Pre-assembly preparation

The inner surface of the steering tube must be clean and free of grease. If necessary, please clean it.

Initial assembly

- ❶ Choose the largest cone that fits the steering tube (**pic.1**).
- ❷ Assemble the adapter, cone, bush and nut (**pic 2**). Torque down all parts with the screw so that you can push the system with little pressure into the steering tube.
- ❸ Bring the adapter into line with the driving direction and tighten the screw. For easy tightening of the screw, place the Dirtboard on the adapter first (**pics. 3 & 4**).

GRAND D.A.D. assembly

Push the Dirtboard from underneath on to the adapter and lock it using the locking mechanism.

Dis-assembly of the GRAND D.A.D.

Push the locking mechanism in the direction of opening in order to take off the Dirtboard adapter.

Horizontal Adjustability

Push the locking mechanism backwards (**pic.7**) and pull off the orange security clips (**pic. 8**) with a screwdriver. Bring the front and back bracket in the right position. The brackets should be close to the crown of the front fork (**pic.9**). To fix the brackets push the orange security clips in and pull the locking mechanism forwards (**pic.10**).

Vertical Adjustability

Adjust the security flap on the front Dirtboard (**pic.11**) and put it in the right position (3-step sequence) (**pic.12**). Please make sure that the security flap is engaged.

SAFETY NOTICE

Before riding always check the position and fixing of the adapter. The GRAND D.A.D. should not come into contact with the tyre or fork arch when the suspension fork is fully depressed.