

Parts

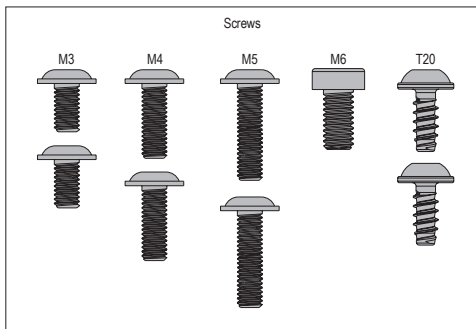

M3	M4	M5	M6	T20
FOX	ÖHLINS	ROCKSHOX	ROCKSHOX SUNTOUR	ADAPTER PLATTE/PLATE

Mounting preparation

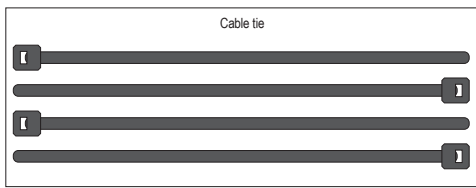
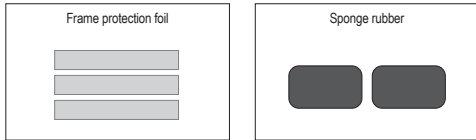
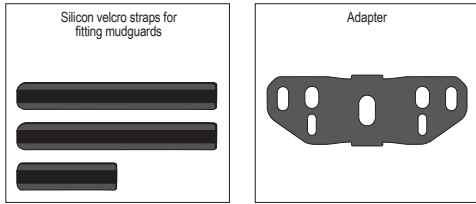
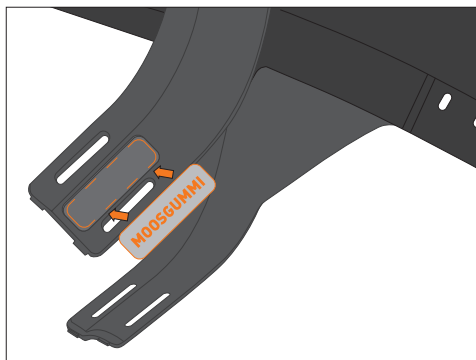

Adhere the foam rubber to the mudguard (outer part)

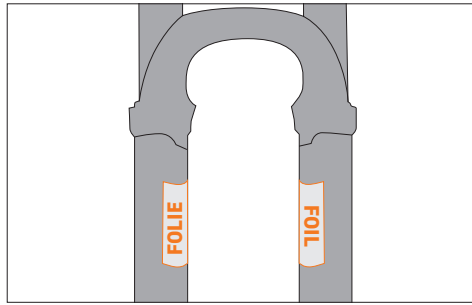

Apply the protective frame film to the down tube.

1. Fastening possibility by means of an adapter

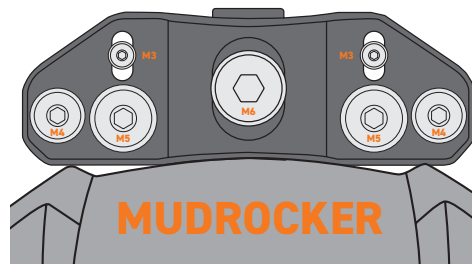

The MUDROCKER FRONT fork adapter has various options for attachment to the fork bridge. Please check in advance whether the existing bolt-on options match those on your fork. The adapter must be fixed at least with the central M6 screw or 2 off-center screws. The adapter can also be rotated 180 degrees. The minimum distance to the tyre, even at full travel, must be kept in mind.

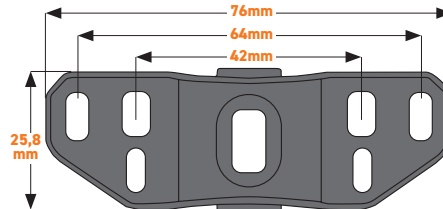

Alignment for Fox

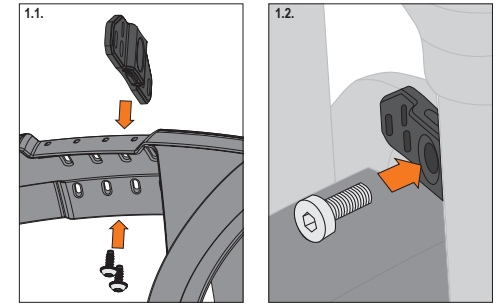

1.1. Screw the adapter onto the mudguard in keeping with the required hole pattern. Use the enclosed self-tapping screws for this. (TX20)

1.2. Screw the adapter onto the fork bridge

2. Fastening possibility

by means of a hook and loop fasteners or cable binders

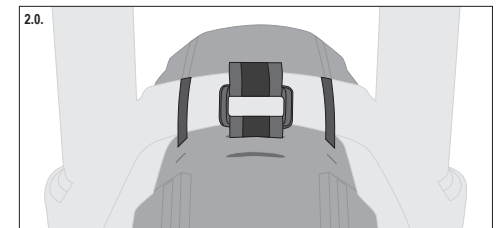

Mounting on the down tube

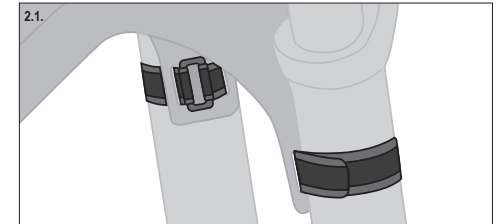

2.1. Thread a long strap through and pull it tight.

PARTS

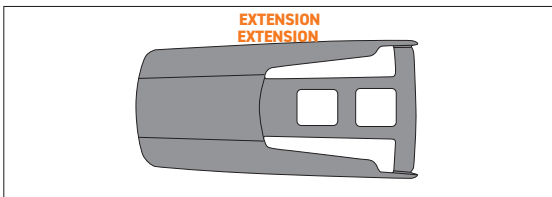
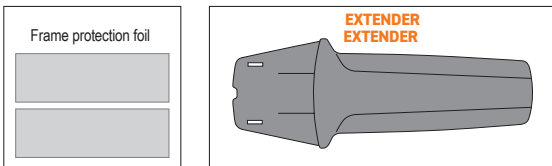
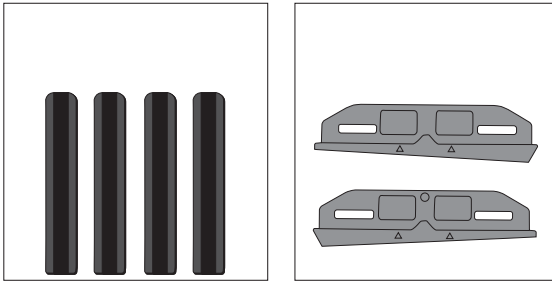

1. Insert the rubberized wedge into the mudguard.

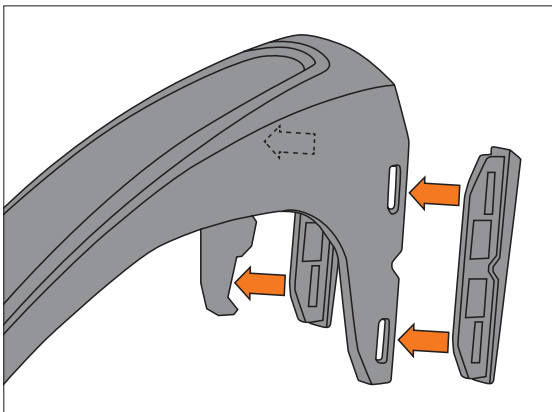

1.1. Adjust the space of the mudguard to the tyre. (2 positions possible)

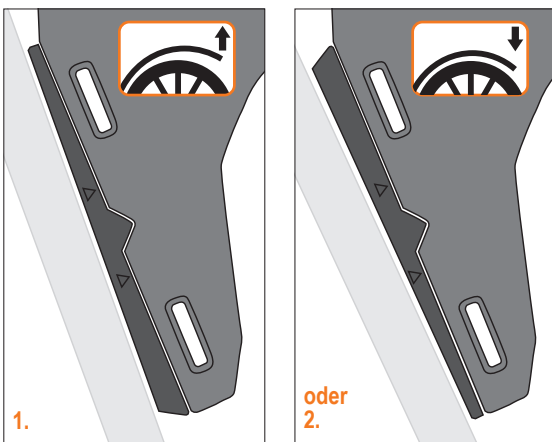

ATTENTION!

We strongly recommend to use the frame protection film.

1.2. Affix the protective film on the bicycle frame.
(Thoroughly clean the frame before affixing)

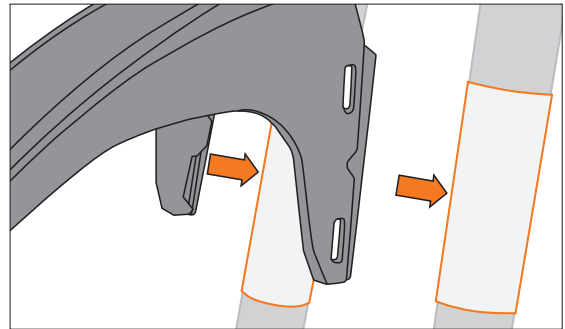

2. Thread the velcro strap with the rubberized side to the frame.
Always retighten the straps before the ride!

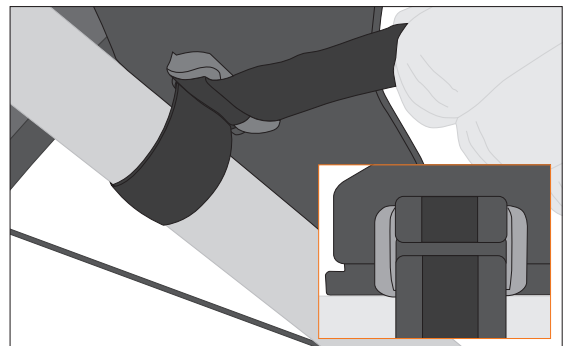

End position strap

3. Optional

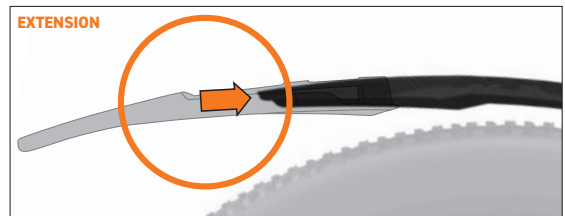

ATTENTION!

Clamp the extender in the mudguard and cut it so that it fits between the seating stays. Avoid in general the contact to the seating stays.

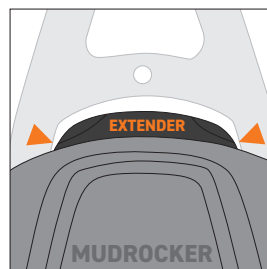

Riding in rough terrain, short contacts of the mudguard and the tyre may occur.



1. Using a 6 mm drillbit, drill a hole through the mudguard and extension at the marked location.

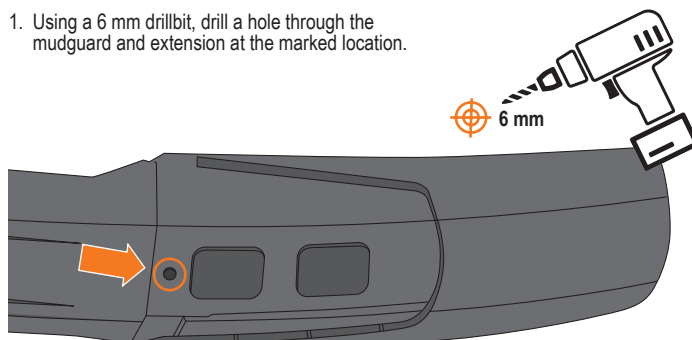

2. Insert the plug from the outside through the two superimposed holes.

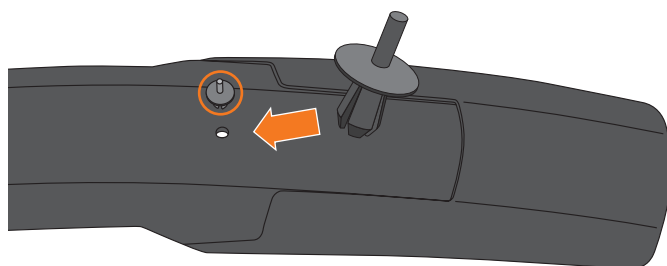

3. Press down the protruding pin with a tool if necessary. This expands the plug and it is firmly installed.

