

**Parts**

To item 1.  
Various parts for stay-assembling

To item 2.+3.+4.  
Various parts for mounting the fenders

Slidingbridge

Spacers for forks with disc brakes

**ATTENTION!**  
Keep the minimum distance of 15 mm between fender and tyre.

**1. Stay-assembling front + rear**

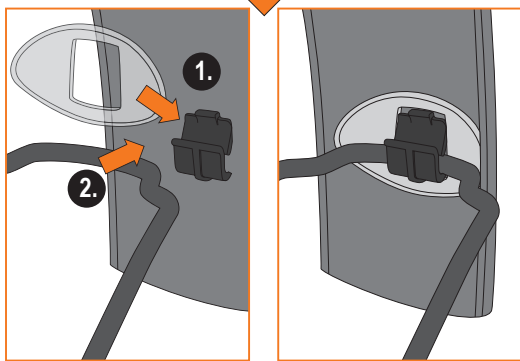
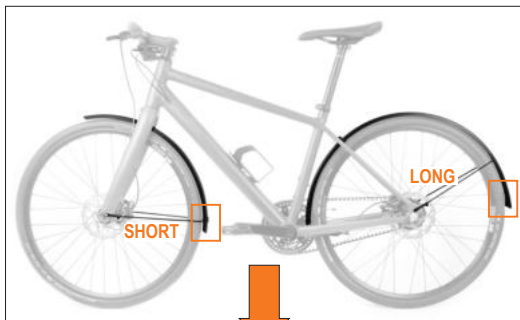
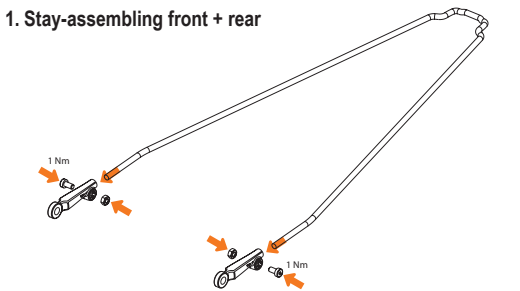

**2. Frame mounting front**

**2.1 Brake-fitting front**

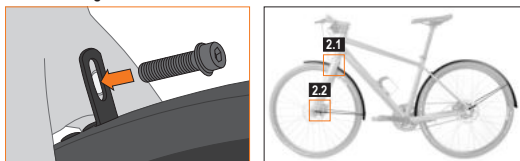

**2.2 Stay attachment front incl. lengths adjustments of the stays**  
**Please note.** In the case of forks with a bore in the direction of travel, an accessory kit is required.

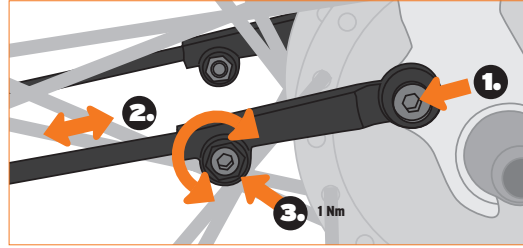

**3. Frame mounting rear**

**3.1 Remove the rear wheel**

**3.2 Assembling of sliding bridge 90° degree angle**

**3.2.1 Screw the sliding bridge**

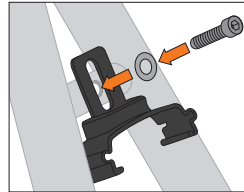

**3.2.2 Clip the fender on the sliding bridge**

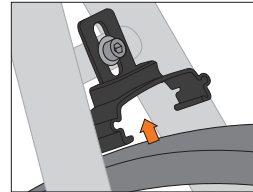

**3.3 Assembling of sliding bridge 0° degree angle**

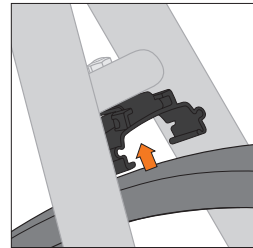
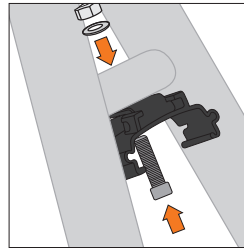

**4. Assembling at the bottom bracket**

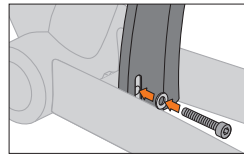

**5. Remount the rear wheel**

**6. Rear stay assembling**

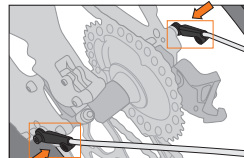

**6.1 Stay attachment rear incl. lengths adjustments of the stays**

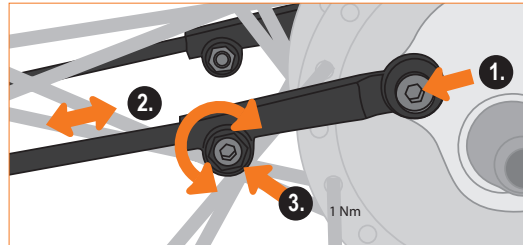

**ATTENTION!** Mounting of spacers for frames with disc brakes

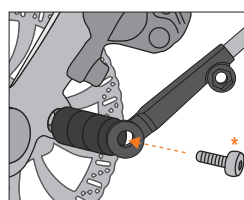

\* Screw is not included in the scope of delivery