



COMPIT + COMPIT⁺

Instructions for Use Version: 03/2019



CONTENTS

Information concerning the Instructions and the Manufacturer	4
Keep the instructions at hand	4
Design characteristics of these instructions	4
Copyright	5
Address of the Manufacturer	5
Safety	6
Intended Use	6
Basic Safety Instructions	7
Avoid fire, explosions or electric shocks	7
Avoid a cardiac pacemaker or other implant failure	7
Design characteristics of the warning instructions	8
Design characteristics of property damage	8
Design characteristics of tips	8
Description	9
COMPIT scope of delivery overview	9
COMPIT+ scope of delivery overview	11
COMPIT Overview	13
COMPIT with COM/LIGHT overview	14
COM/LIGHT overview	15
+COM/UNIT overview	16
LED status indicator	17
Task and Function	18
COMPIT	18
COMPIT+	18
Technical Data	19
Unpacking and Checking the Scope of Delivery	20
Mounting the COMPIT on the Handlebars of the Bicycle and Removing it	21
Requirement	21
Without COM/LIGHT	22
With COM/LIGHT	25
Mounting the Smartphone on the COMPIT and Removing it	30
Adjusting the Inclination	32
Charging the Smartphone via the +COM/UNIT	33
Cableless charging of the smartphone	33
Charging the smartphone with a cable	35
Using the NFC	36
Charging the +COM/UNIT	37
Troubleshooting	38
Caring for the Product	39
Accessories	40
Disposing of the Product	41
In Germany	41
Outside Germany	41
Warranty Declaration	42
Returns to Customer Service	43

Information concerning the Instructions and the Manufacturer

These instructions help you to use the "COMPIT" and "COMPIT+" product range safely.

The COMPIT is a smartphone holder for smartphones.

The COMPIT+ comprises the COMPIT and the +COM/UNIT.

The +COM/UNIT is a charging and communication station for smartphones.

The COMPIT and the +COM/UNIT are hereafter referred to as the "product" as long as it is not necessary to differentiate between different product functions.

Keep the instructions at hand

- These instructions are a constituent part of the product.
- Always keep these instructions.
- Please pass these instructions on if you sell the product or pass it on in another form.

Design characteristics of these instructions

Various elements in these instructions include clearly determined characteristics. You can easily differentiate between the following elements:

Normal text

- Enumerations
- Action steps

DESIGNATION OF PRODUCTS

Copyright

These instructions include information that is protected by copyright. These instructions are not to be copied, printed out, filmed, processed, duplicated or distributed in any form whatsoever, whether in part or in its entirety without prior written approval of SKS metaplast Scheffer-Klute GmbH.

©2019 SKS metaplast Scheffer-Klute GmbH

All rights reserved.

Address of the Manufacturer

SKS metaplast Scheffer-Klute GmbH

Zur Huberstushalle 4

59846 Sundern, Germany

Tel.: +49-2933-8310

Website: www.sks-germany.com

Safety

Intended Use

The product is designed for private use.

The COMPIT serves to mount a smartphone on the handlebars of the bicycle. It is designed for use with handlebars with the following diameters:

- 22.2 mm
- 25.4 mm
- 31.8 mm.

The max. front-end width is 49 mm (please refer to page 21).

The scope of delivery of the COMPIT + also includes the +COM/UNIT.

The +COM/UNIT is designed for the charging of smartphones with or without a Qi charging function and it can be mounted on the COMPIT.

The smartphone and the +COM/UNIT can only be used on the COMPIT together with a cover that is not included in the scope of delivery, please refer to the section headed Accessories, page 40.

The intended use also includes the observing and adhering to all of the information in these instructions, especially the safety instructions. Any other use is explicitly deemed to be not an intended use.

Basic Safety Instructions

Avoid fire, explosions or electric shocks

Severe or mortal injuries resulting from an explosion, fire or electric shock are possible should the product not be used correctly.



- Check whether the voltage stated on the power adapter is the same as the local mains voltage before you connect the adapter to the power supply.
- Always only use authorised power adapters.
- Do not use the COMPIT or +COM/UNIT power adapter should it be damaged.
- Never open the housing of the COM/UNIT. Always have repair work carried out by qualified specialists.
- Do not adhere any metallic labels or other objects to the +COM/UNIT.
- Do not use the +COM/UNIT close to heated surfaces.
- Do not use an extension cable or overloaded multiple sockets.
- Ensure that children and persons with a mental handicap only use the +COM/UNIT under supervision.

Avoid a cardiac pacemaker or other implant failure

A cardiac pacemaker or other implant failure can occur when using the +COM/UNIT.

- Should you have a cardiac pacemaker or another implant, please consult your doctor or the implant manufacturer before using the +COM/UNIT.

Design characteristics of the warning instructions

 CAUTION	
	Instructions with the word CAUTION warn of a situation that could result in slight or moderate injuries.

Design characteristics of property damage

IMPORTANT	
	These instructions warn of a situation that could cause property damage and restricted functions.

Design characteristics of tips

 Tips provide additional information.

Description

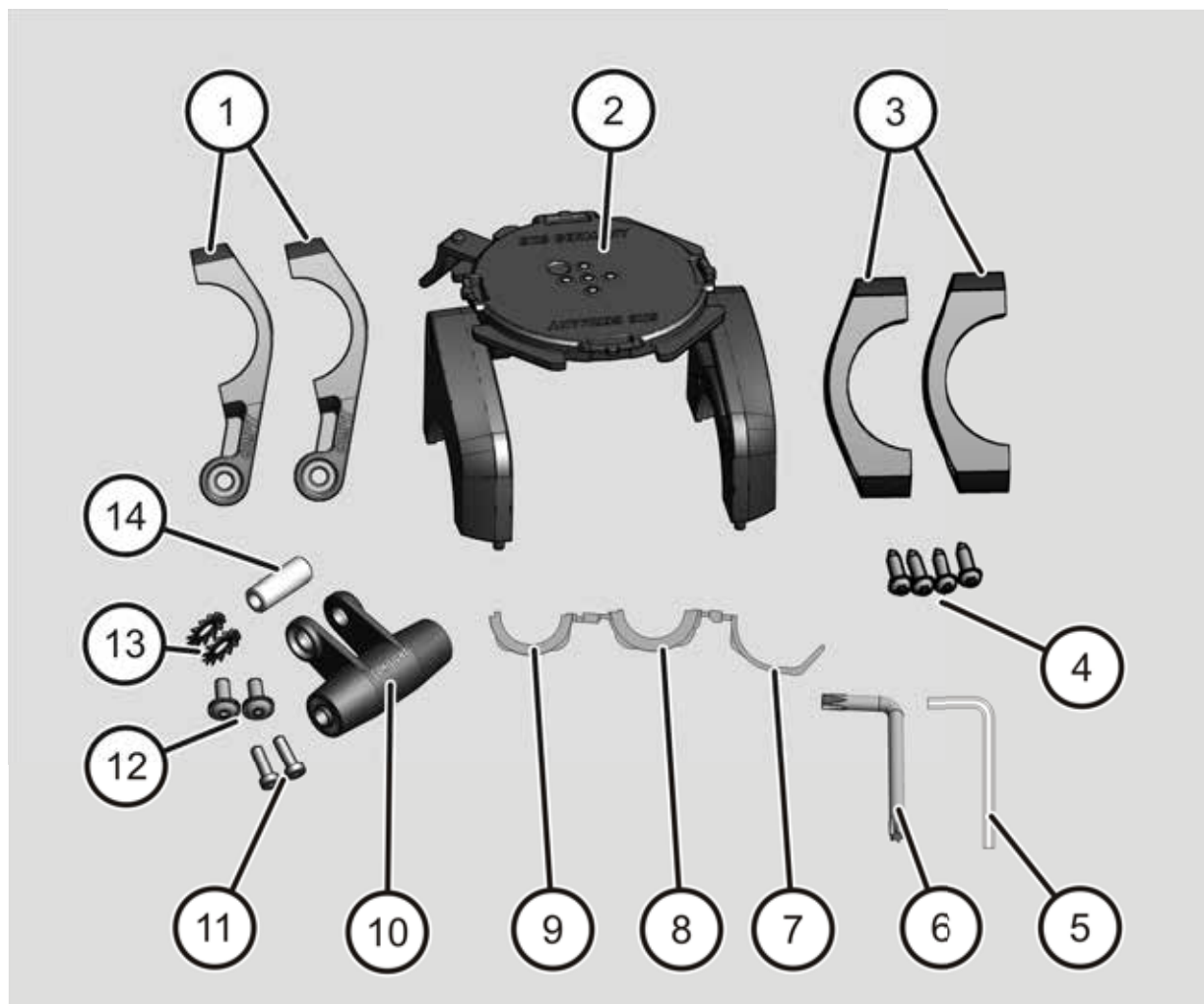

No.	Designation
1	Clamping arms for the COMPIT with an adapter (R: right, L: left), 2x
2	Docking station for mounting the smartphone with a cover or the +COM/UNIT
3	Clamping arms for the COMPIT without an adapter
4	Screws for mounting the COMPIT with clamping arms on the handlebar of the bicycle (4x20), 4x
5	Allen key 3 mm

Description

No.	Designation
6	TorxR key Tx20
7	Rubber adapter for handlebars with a diameter of 31.8 mm, 4x
8	Rubber adapter for handlebars with a diameter of 22.2 mm, 4x
9	Rubber adapter for handlebars with a diameter of 25.4 mm, 4x
10	COM/LIGHT adapter
11	Screws for mounting the COM/LIGHT adapter (M5x16)
12	Screws for mounting the front light (M4x8), 2x
13	Locking washer for mounting the front light, 2x
14	Shaft for mounting the front light

ⓘ The cover and the front light are not included in the scope of delivery.

COMPIT⁺ scope of delivery overview

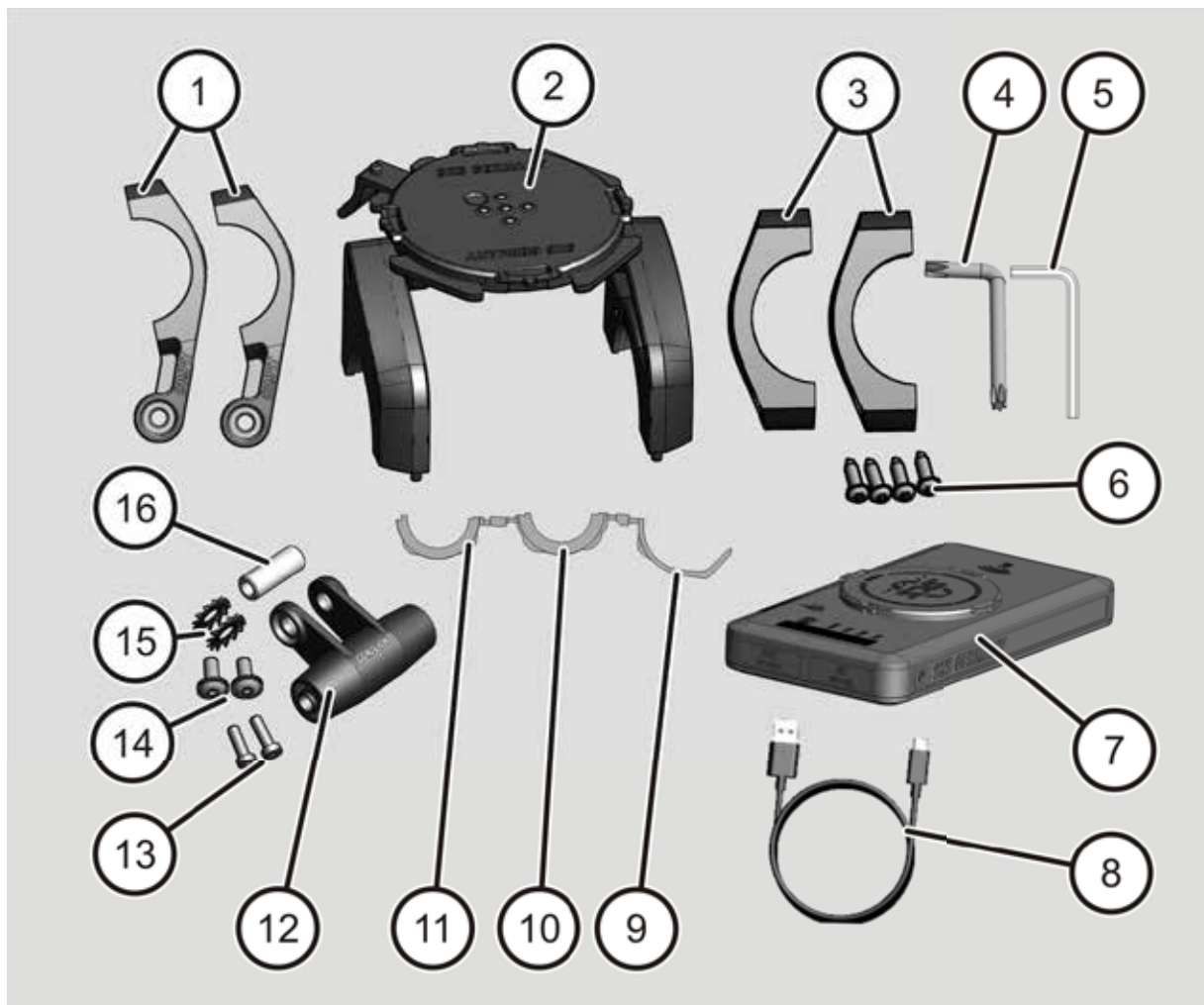

No.	Designation
1	Clamping arms for the COMPIT with an adapter (R: right, L: left), 2x
2	Docking station for mounting the smartphone with a cover or the +COM/UNIT
3	Clamping arms for the COMPIT without an adapter, 2x
4	TorxR key Tx20
5	Allen key 3 mm
6	Screws for mounting the COMPIT with clamping arms on the handlebar of the bicycle (4x20), 4x
7	+COM/UNIT

Description

No.	Designation
8	USB cable for charging the +COM/UNIT
9	Rubber adapter for handlebars with a diameter of 31.8 mm, 4x
10	Rubber adapter for handlebars with a diameter of 22.2 mm, 4x
11	Rubber adapter for handlebars with a diameter of 25.4 mm, 4x
12	COM/LIGHT adapter
13	Screws for mounting the COM/LIGHT adapter (M5x16), 2x
14	Screws for mounting the front light (M4x8), 2x
15	Locking washer for mounting the front light, 2x
16	Shaft for mounting the front light

① The cover and the front light are not included in the scope of delivery.

COMPIT Overview

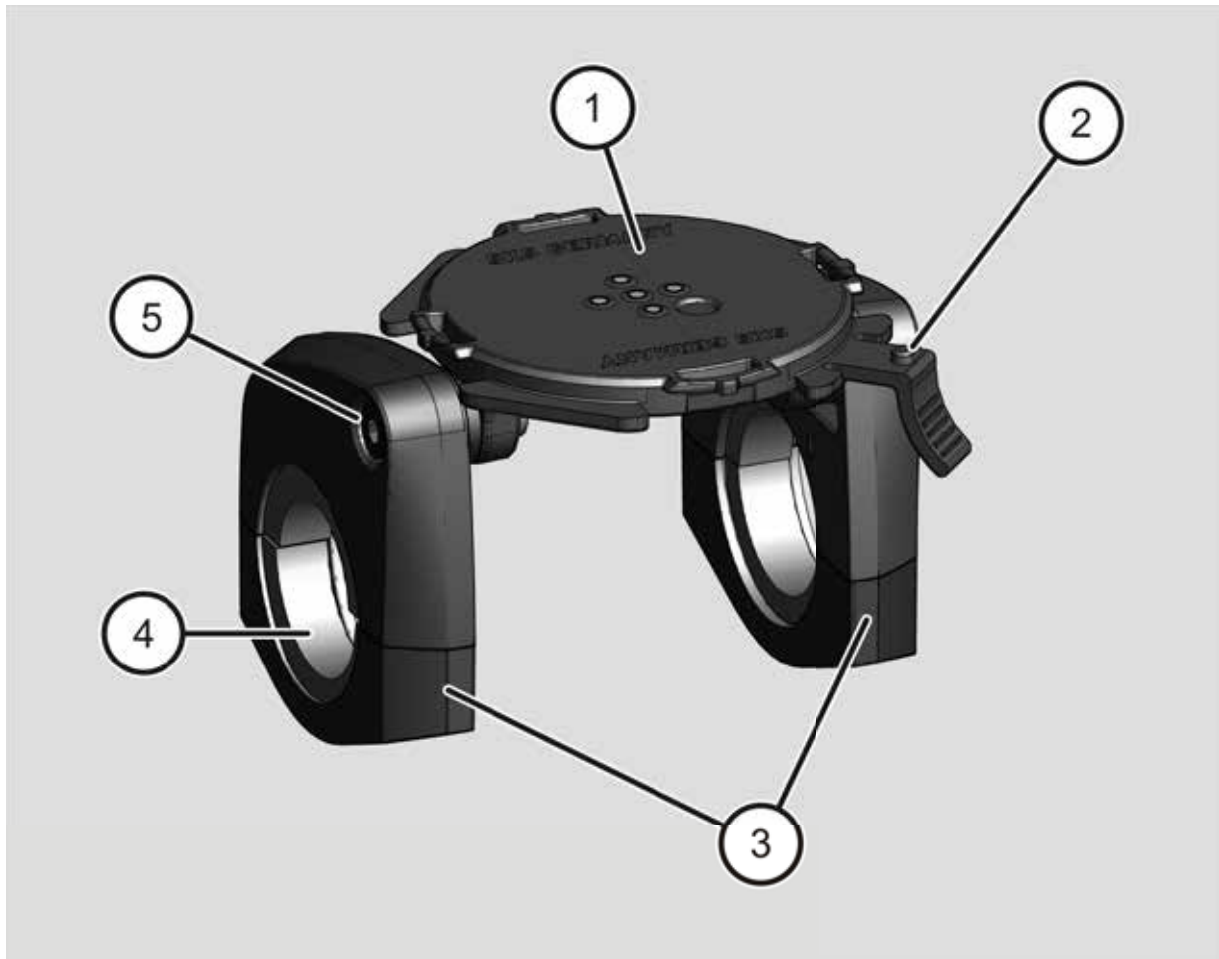

No.	Designation
1	Docking station for mounting the smartphone with a cover or the +COM/UNIT
2	Safety lever for locking the smartphone with cover or the + COM/UNIT in place
3	Clamping arms
4	Rubber adapter (on both sides)
5	Inclined screw (on both sides)

COMPIT with COM/LIGHT overview

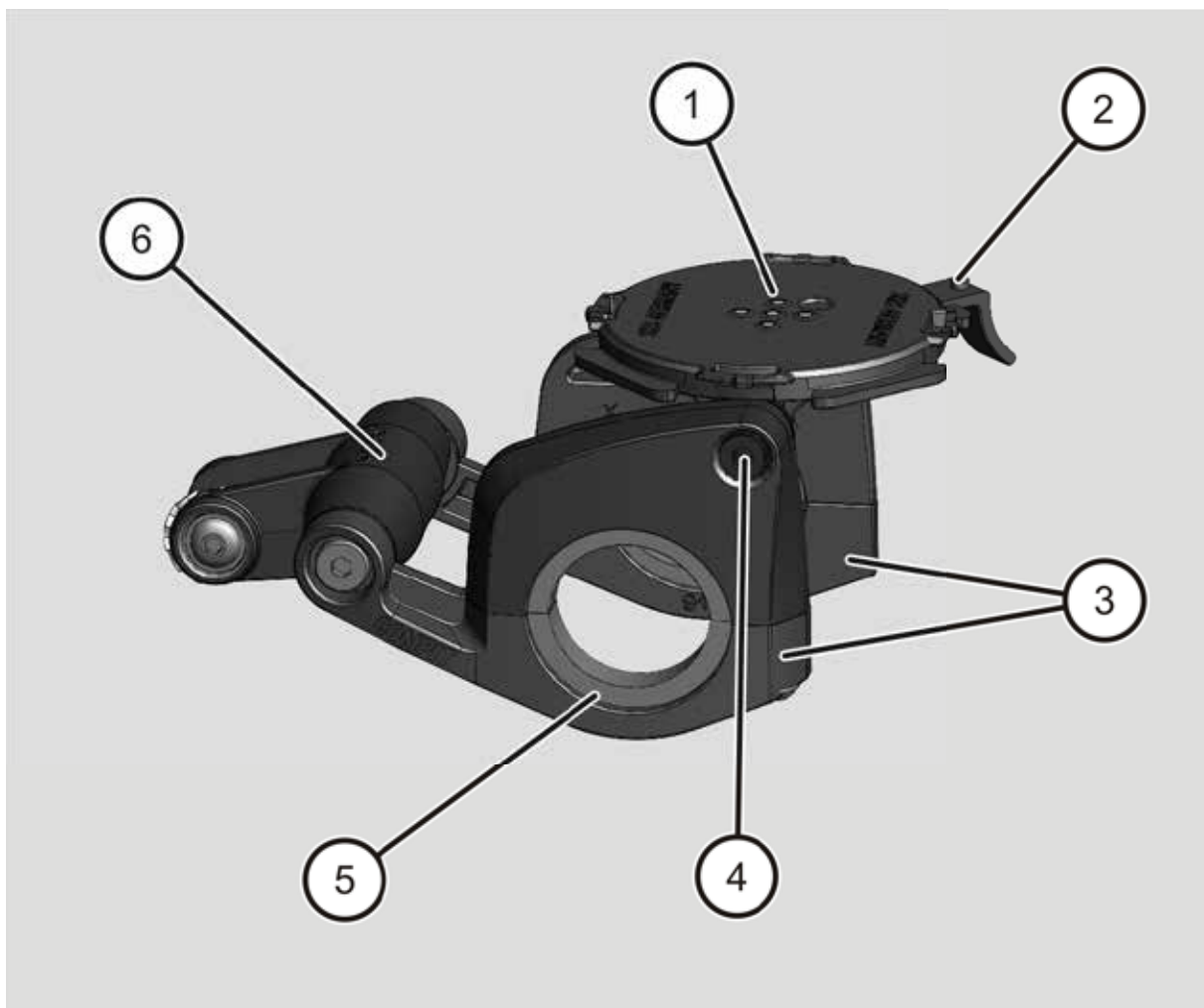

No.	Designation
1	Docking station for mounting the smartphone with a cover or the +COM/UNIT
2	Safety lever for locking the smartphone with cover or the + COM/UNIT in place
3	Clamping arms
4	Inclined screw (on both sides)
5	Rubber adapter (on both sides)
6	COM/LIGHT

COM/LIGHT overview

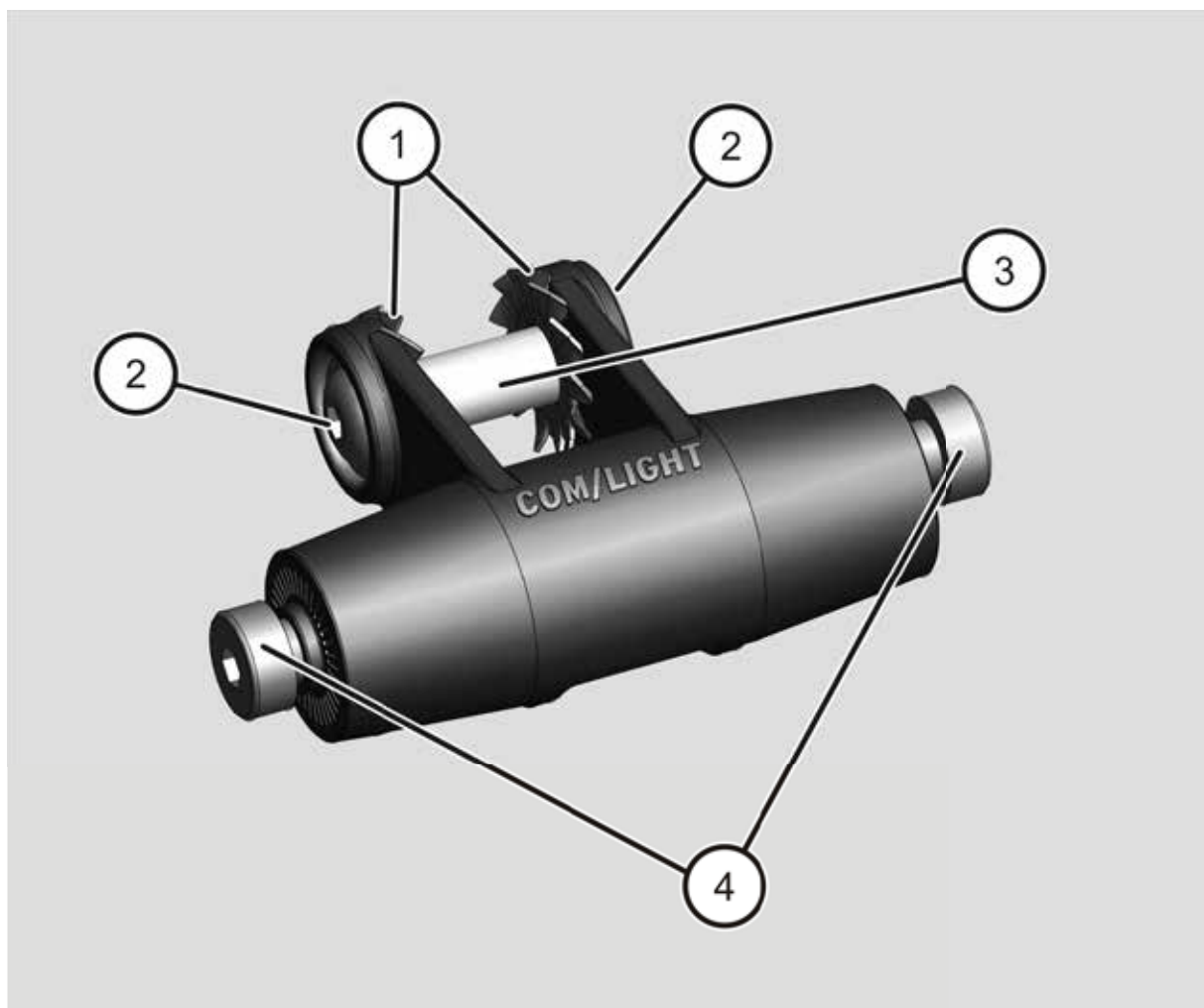

No.	Designation
1	Locking washer for mounting the front light
2	Screws for mounting the front light (M4x8)
3	Shaft for mounting the front light
4	Screws for mounting the COM/LIGHT adapter (M5x16)

+COM/UNIT overview

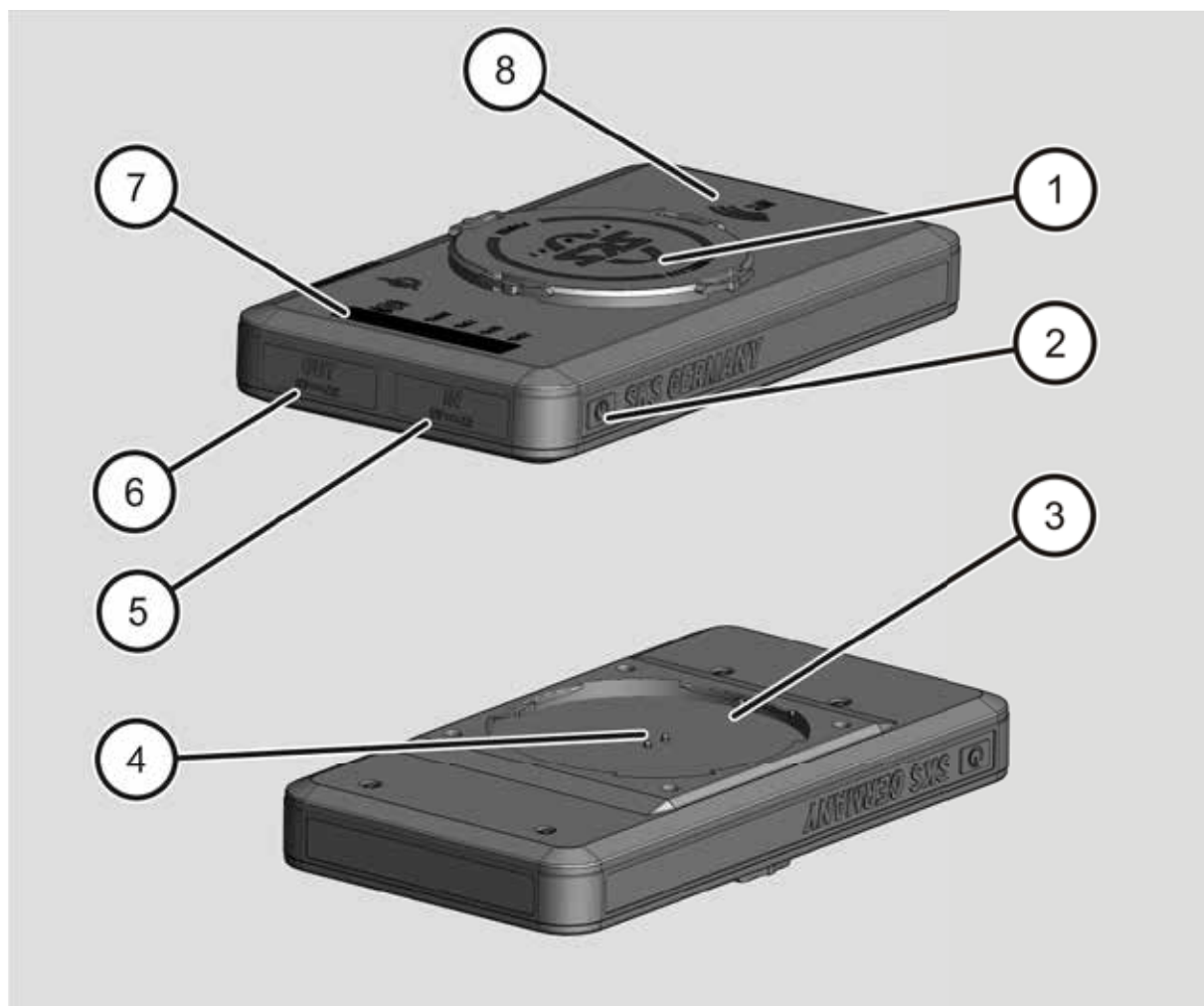

No.	Designation
1	Qi docking station (cableless charging) for mounting the smartphone with cover
2	Button for switching on and off
3	Docking station for mounting on the COMPIT
4	4 Housing input (two contact pins in the housing)
5	USB-Input
6	USB-Output
7	LED status indicator
8	NFC reading area

LED status indicator

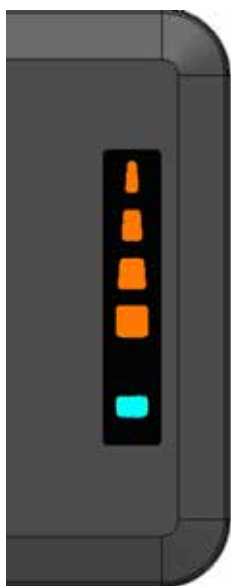
+COM/UNIT	LED	Status	Indicates
	Battery indicator	4 orange LEDs flash in succession	+COM/UNIT is being charged
		1 LED illuminated	0%-25% battery capacity
		2 LEDs illuminated	25%-50% battery capacity
		3 LEDs illuminated	50%-75% battery capacity
		4 LEDs illuminated	75%-100% battery capacity
	Indicator for cableless charging	Blue	Standby or charging completed
		Blue flashing approx. 1 x per second	Charging in process
		Blue flashes fast approx. 5x per second	Charging error

Task and Function

COMPIT

The COMPIT serves to mount the smartphone on the handlebars of the bicycle. The smartphone can be mounted horizontally or vertically over the docking station on the COMPIT by it being turned with the assistance of an optional cover. The inclined positioning makes it possible to place the smartphone in the required position on the COMPIT.

The COM/LIGHT adapter can be used on the COMPIT in order to mount the front light that is not included in the scope of delivery. The COM/CAM adapter that is also not included in the scope of delivery can also be mounted on the COMPIT for the purpose of mounting a camera.

COMPIT+

The +COM/UNIT is additionally included in the COMPIT + scope of delivery.

The +COM/UNIT serves to charge and connect the smartphone during the journey. It can be mounted on the COMPIT. Smartphones that are equipped with a cableless charging function are charged by the smartphone being mounted on the Qi docking station. Smartphones that do not have a Qi charging function can be charged using an optional USB cable. It is mounted with the assistance of a cover that is not included in the scope of the delivery, it then being possible to turn it over the docking station.

The inclined positioning makes it possible to place the +COM/UNIT in the required position on the COMPIT.

The +COM/UNIT is equipped with an NFC chip (NEAR FIELD COMMUNICATION). This can be provided with various functions.

The + COM/UNIT can be charged using the USB cable that is included in the scope of delivery.

Technical Data

+COM/UNIT	
Dimensions	130 x 70 x 21,5 mm
Weight	~188 g
USB-Input	DC 5 V/2 A
USB-Output	DC 5 V/2 A
Housing input*	DC 5-15 V/2 A
Wireless transmission power	5 W
Wireless efficiency	>70%
Operating frequency	110 KHz-205 KHz
Wireless Output	DC 5 V/1 A
Battery type	Rechargeable lithium-polymer battery
Battery capacity	5000 mAh
NFC-Chip	NTAG 216, 924 Byte
Type of protection	IP54
Operating temperature	-15 ~ 60° C
Charging temperature	0 ~ 45° C

* Only in conjunction with COMPIT/E

Unpacking and Checking the Scope of Delivery

- Remove the product from the packaging.
- Keep the original packaging in case it is necessary to return the product to customer service.
- Check the scope of delivery for correctness and completeness (see from page 9).
- Ensure that none of the parts are damaged.
- Please contact the manufacturer or dealer without delay should there be any deviations.

Mounting the COMPIT on the Handlebars of the Bicycle and Removing it

Requirement

You can mount the COMPIT on the bicycle as long as your bicycle meets the following requirements:

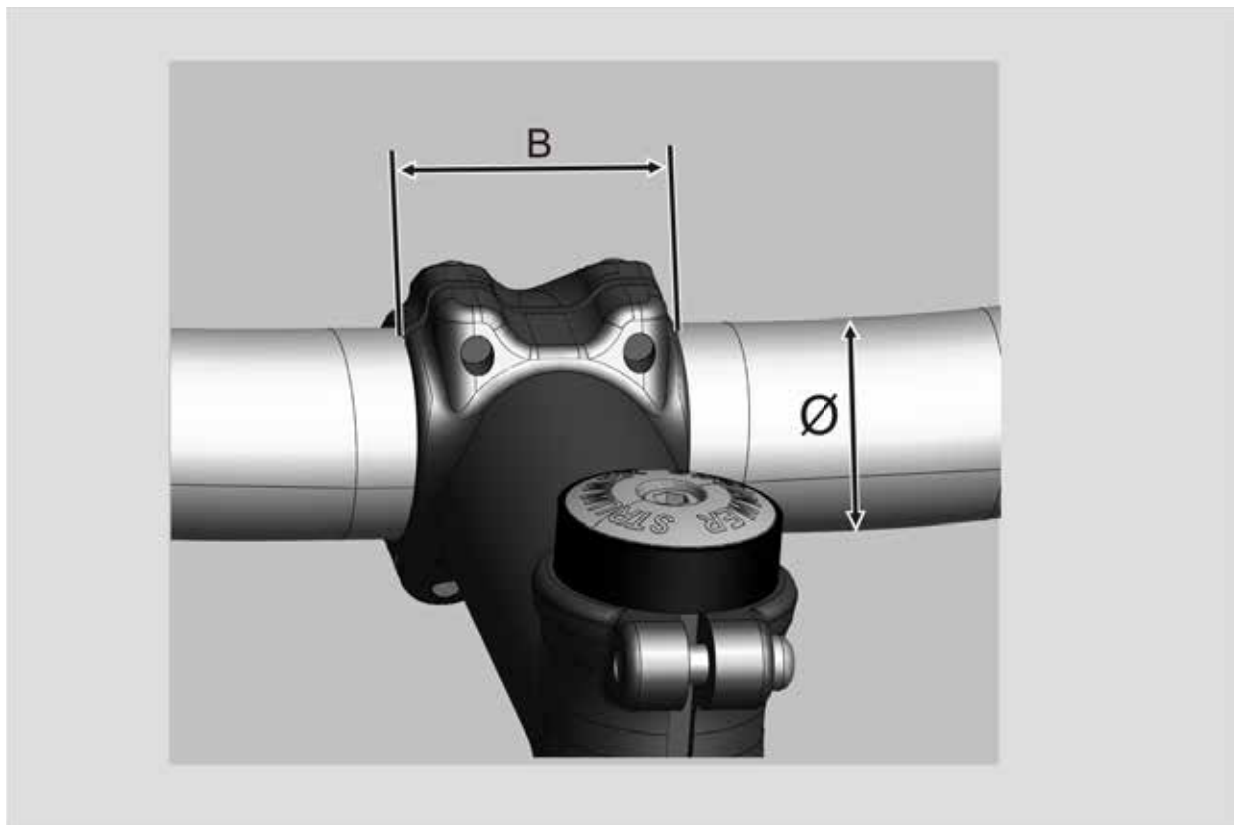

Designation	Explanation
B	Maximum front-end width 49 mm
Ø	Diameter of the handlebars: 22.2 mm 25.4 mm 31.8 mm

Without COM/LIGHT

Mount the COMPIT on the handlebars of your bicycle as follows:

- Select the appropriate rubber adapters for the handlebars of your bicycle.
- Insert the required rubber adapters (1) in the clamping arms in the direction of the arrows as shown below.

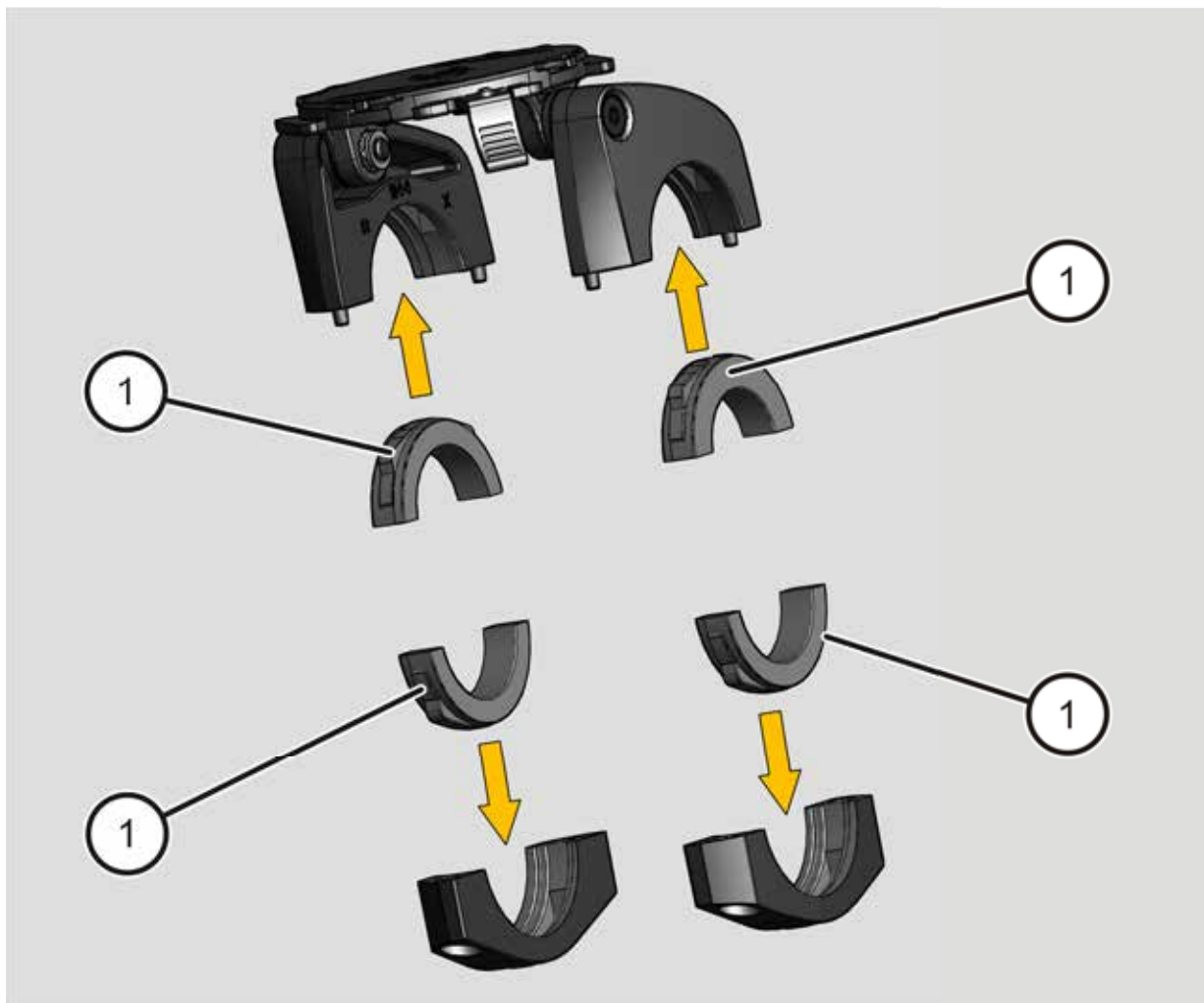

Mounting the COMPIT on the Handlebars of the Bicycle and Removing it

- Mount the COMPIT (2) with the clamping arms (3) on the handlebars of the bicycle.

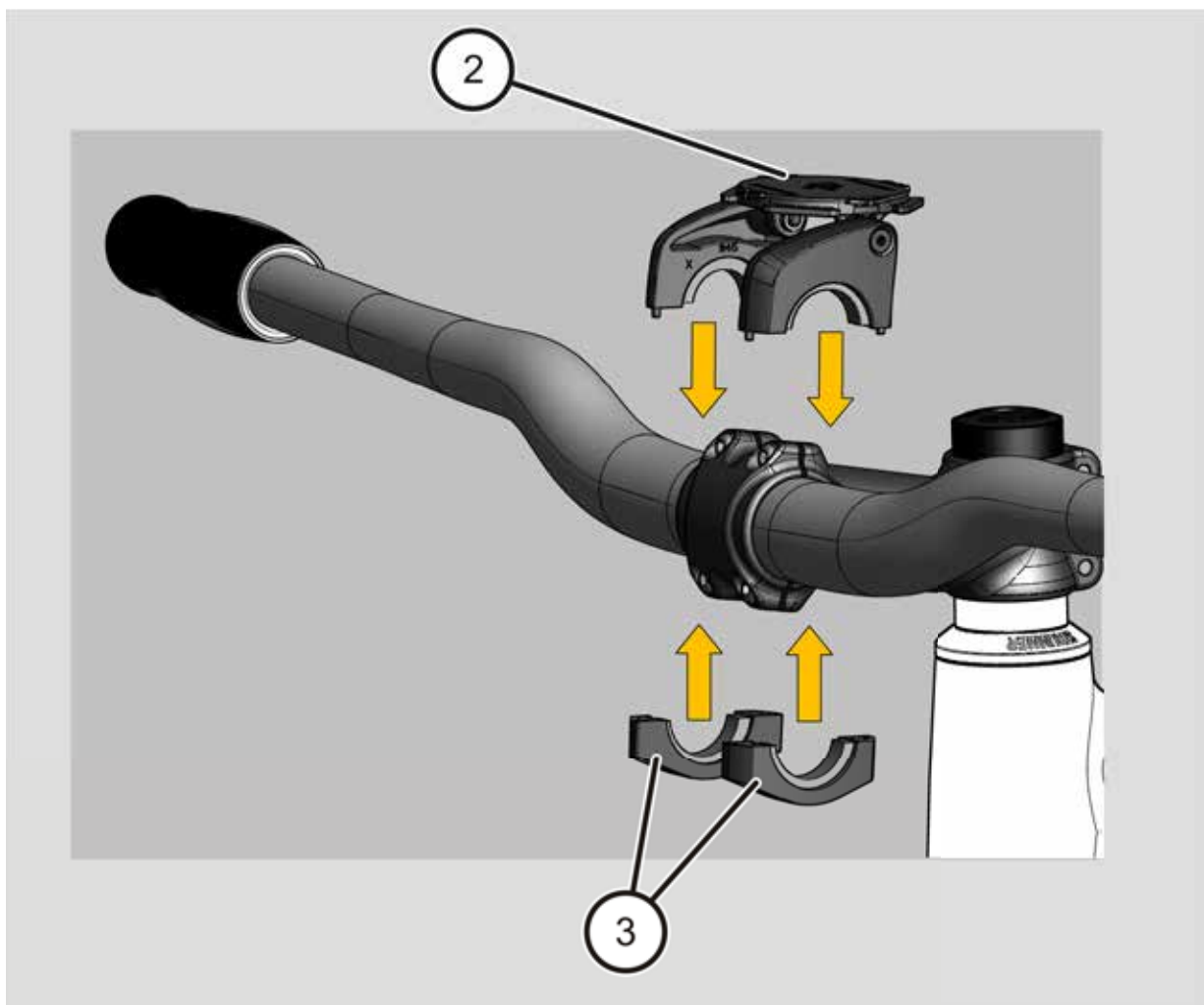

CAUTION



A non-uniform tightening of the screws when mounting the COMPIT on the bicycle can result in the COMPIT becoming detached from the bicycle and causing injuries.

- When mounting the COMPIT, tighten the screws alternately and uniformly.

- Use a torque spanner to mount the COMPIT on the handlebars of the bicycle. To do so, tighten the screws (4) alternately and uniformly applying the torque that is stated on the clamping arms (2 Nm).

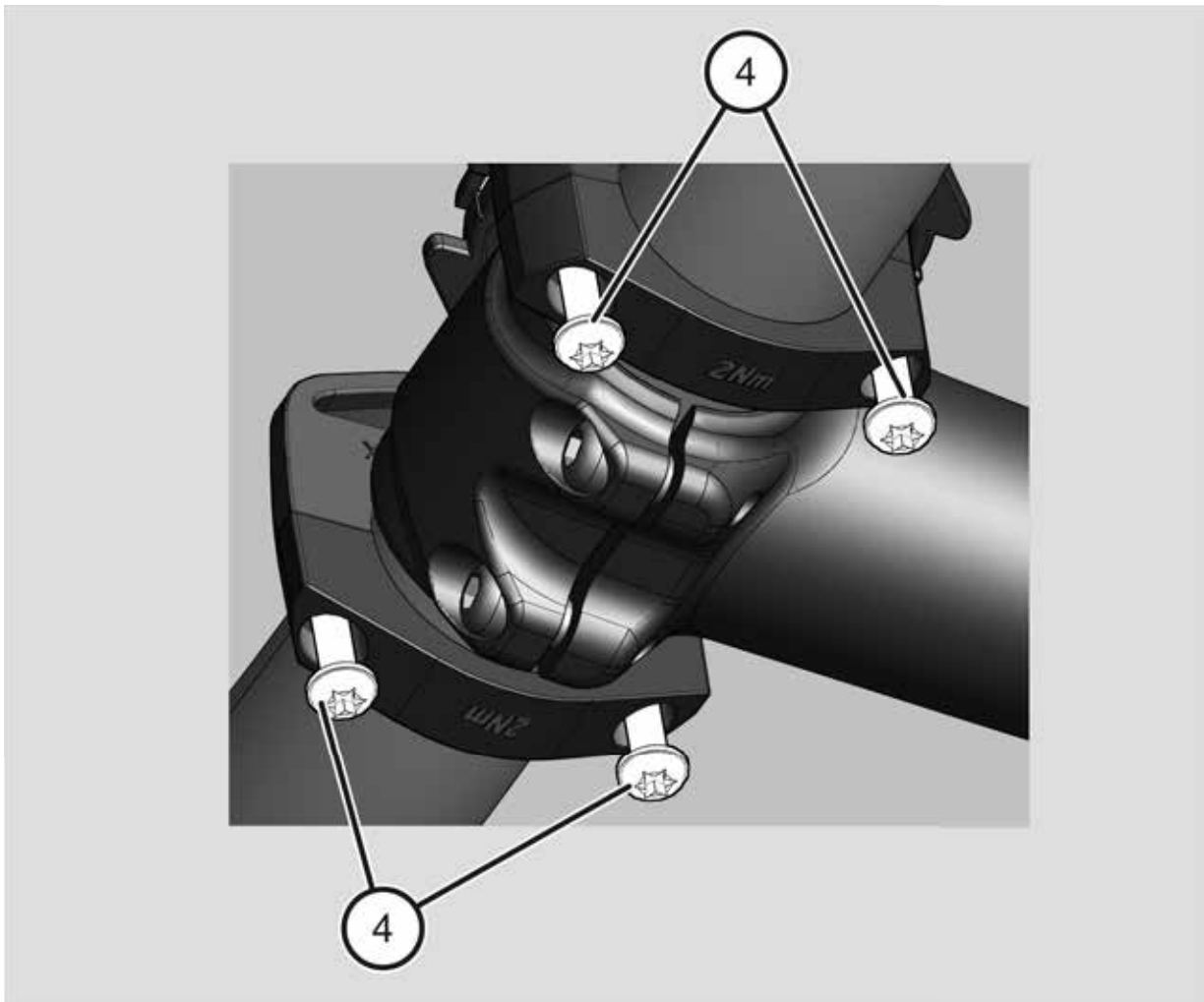

Remove the COMPIT from the handlebars of the bicycle as follows:

- Loosen the screws.
- Remove the COMPIT from the handlebars of the bicycle together with the clamping arms.

With COM/LIGHT

IMPORTANT

The mounting of the COM/LIGHT in the clamping arms after the COMPIT has been mounted on the handlebars of the bicycle can cause damage to the COMPIT.

➤ Mount the COM/LIGHT on the clamping arms first.

Mount the COMPIT on the handlebars of the bicycle as follows:

➤ Mount the clamping arms, R: right, L: left (3) on the COM/LIGHT (2) first and then tighten the screws (1) slightly.

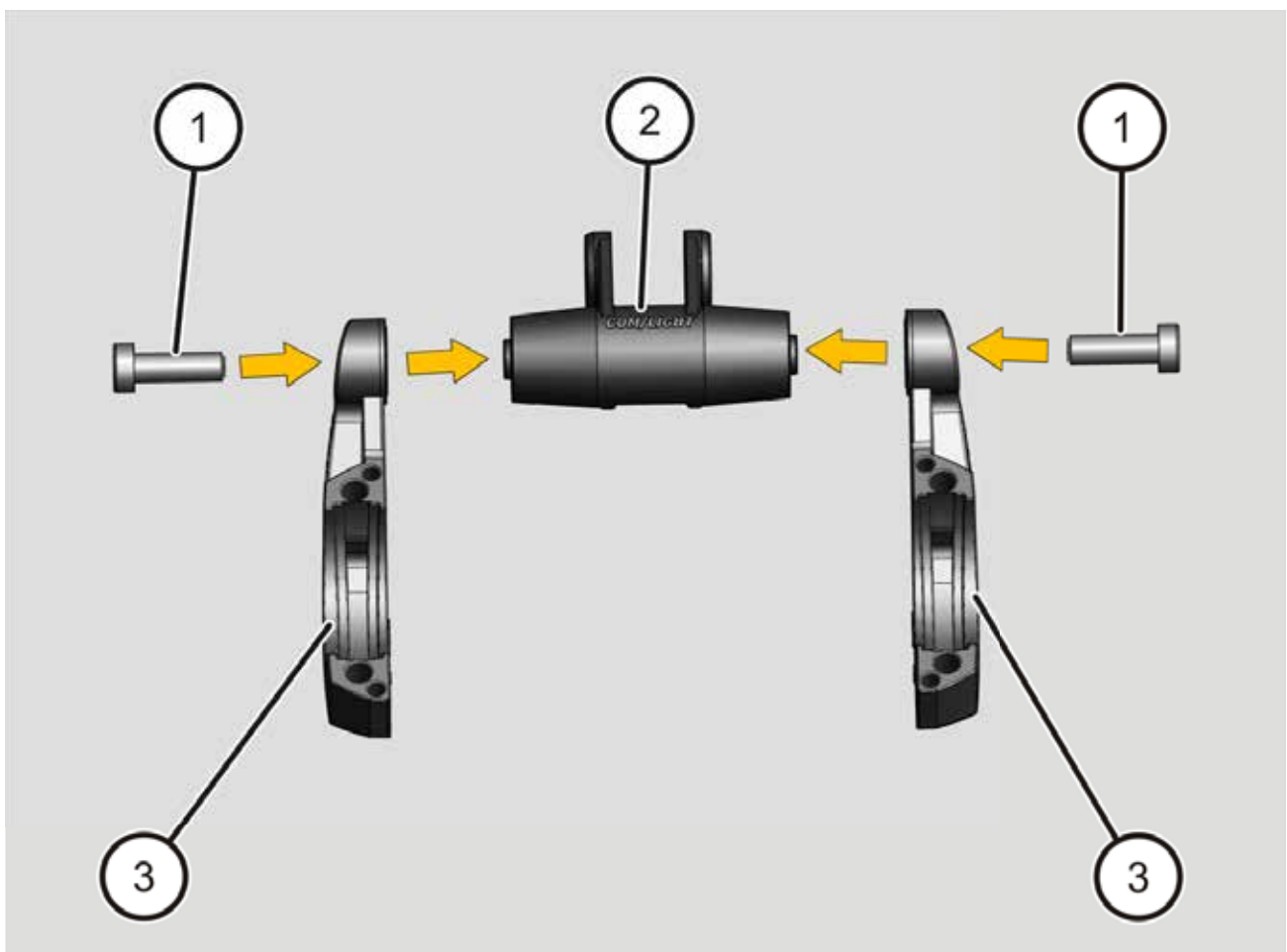

① The optional COM/CAM adapter can be mounted using the clamping arms analogue to the COM/LIGHT.

Mounting the COMPIT on the Handlebars of the Bicycle and Removing it

- Select the appropriate rubber adapters for the handlebars of your bicycle.
- Insert the required rubber adapters (4) in the clamping arms in the direction of the arrows as shown below.

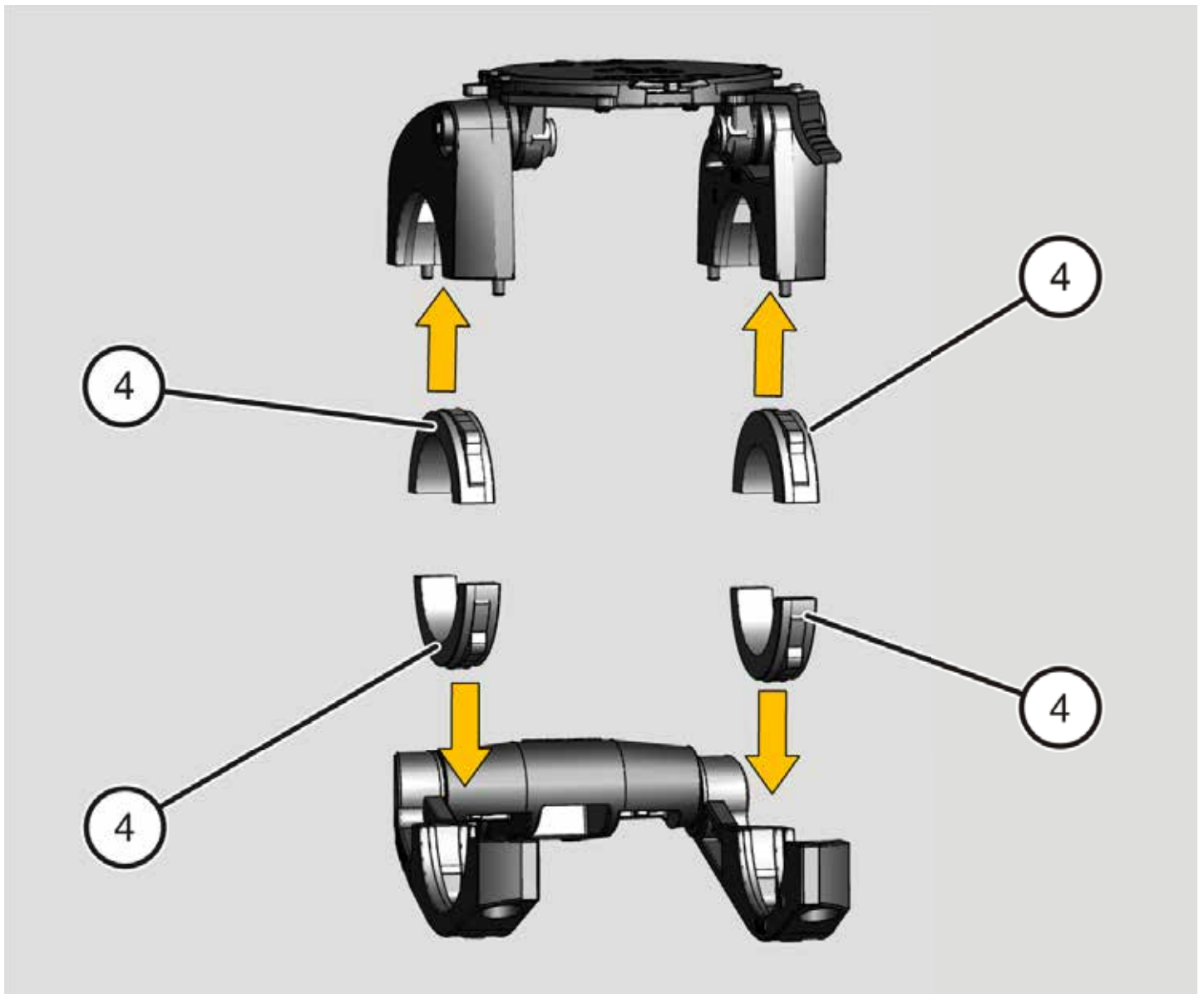

Mounting the COMPIT on the Handlebars of the Bicycle and Removing it

- Mount the COMPIT (5) with the clamping arms (6) on the handlebars of the bicycle.

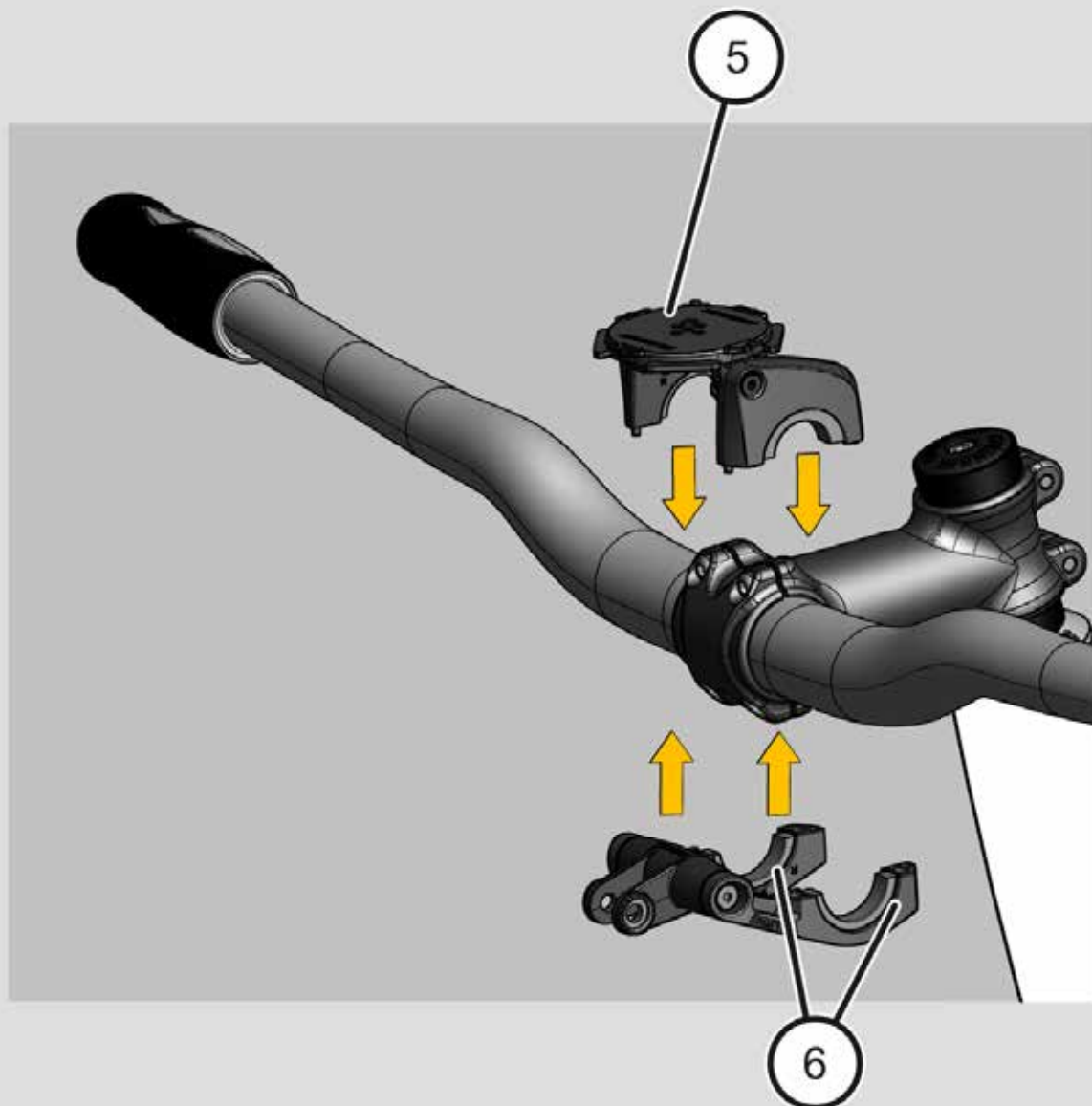

CAUTION



A non-uniform tightening of the screws when mounting the COMPIT on the bicycle can result in the COMPIT becoming detached from the bicycle and causing injuries.

➤ When mounting the COMPIT, tighten the screws alternately and uniformly.

- Use a torque spanner to mount the COMPIT on the handlebars of the bicycle. To do so, tighten the screws (7) applying the torque that is stated on the clamping arms (2 Nm) alternately and uniformly.

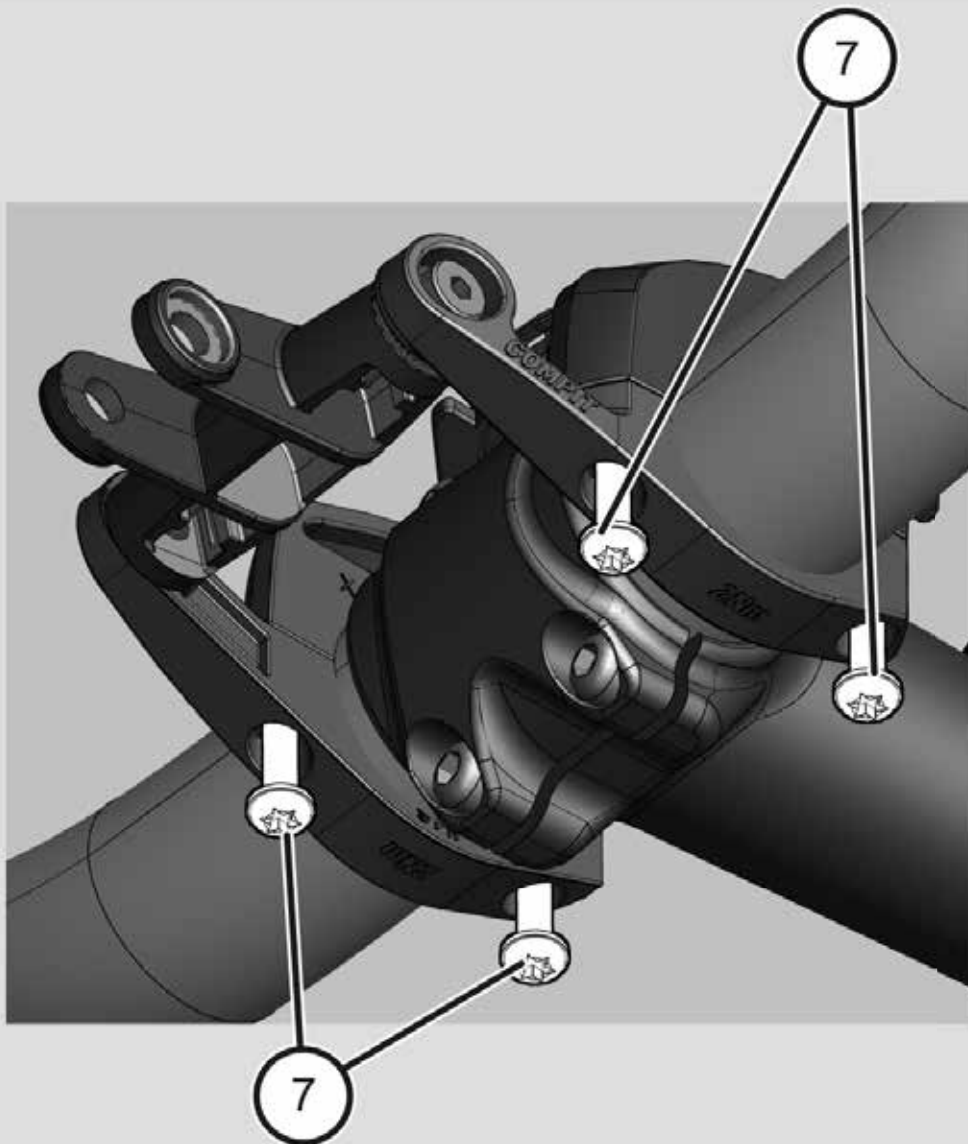

Mounting the COMPIT on the Handlebars of the Bicycle and Removing it

You can mount a front light on the COM/LIGHT after you have mounted the COMPIT on the handlebars of the bicycle. You can do so as follows:

- Insert the base of the front light (11) in the recess in the COM/LIGHT together with the locking washers (10) on each side of the lamp base and align all of the holes.
- Insert the shaft (8) through the recess in the COM/LIGHT and the lamp base.
- Use the enclosed Alley key to tighten both of the screws (9).

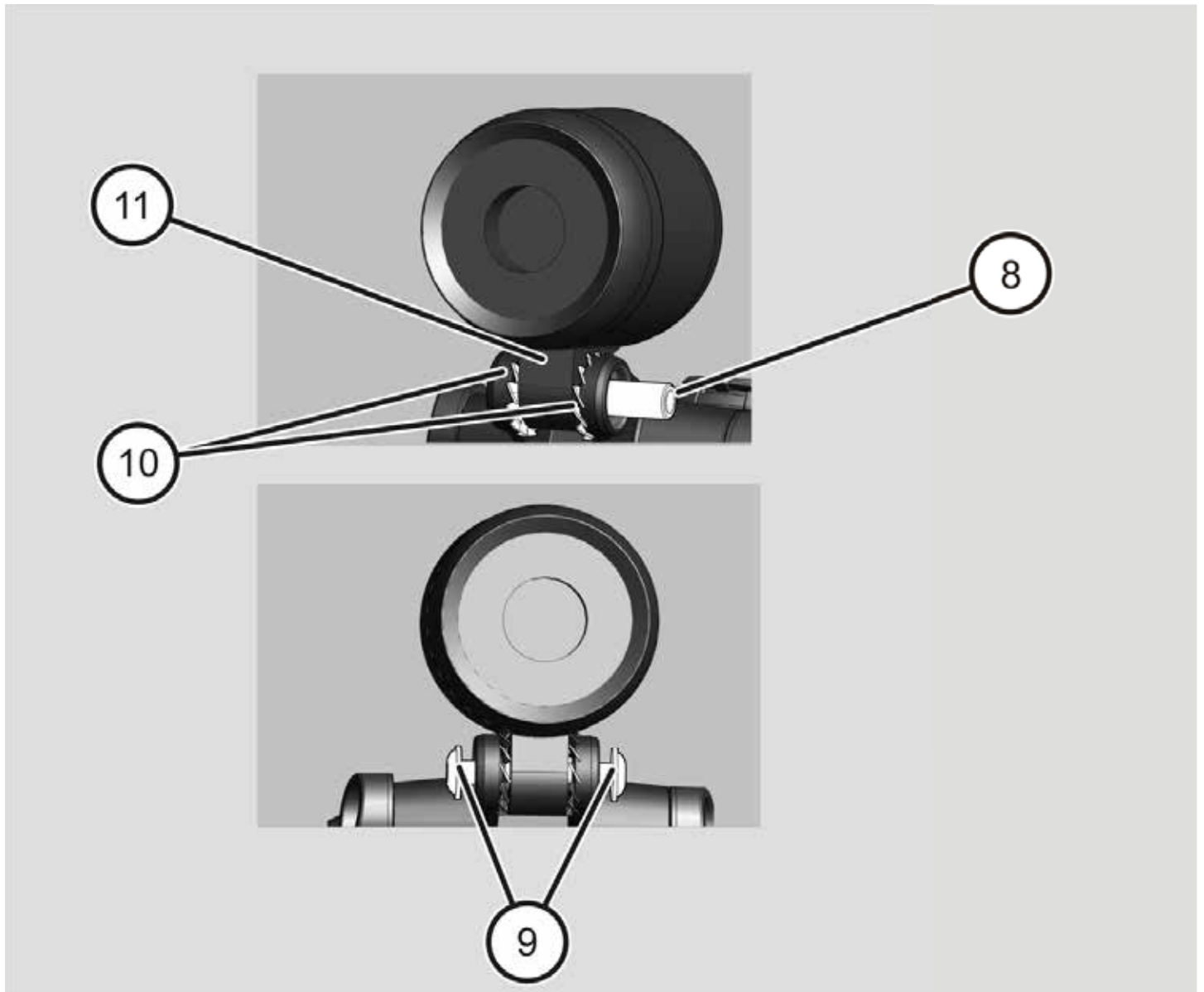

❗ Please take the maximum width of the lamp base of 12 mm and the minimum borehole diameter of 6 mm into account.

The COMPIT is removed from the handlebars of the bicycle as follows:

- Loosen the screws on the COMPIT.
- Remove the COMPIT components from the handlebars of the bicycle.

Mounting the Smartphone on the COMPIT and Removing it

Mount your smartphone on the COMPIT as follows:

- Place your smartphone in the corresponding cover as described in the instructions.
- Place your smartphone on the COMPIT (as shown in 1 or 2) and turn it (by approx. 45 degrees) to the right or to the left over the docking station until it audibly locks into place.

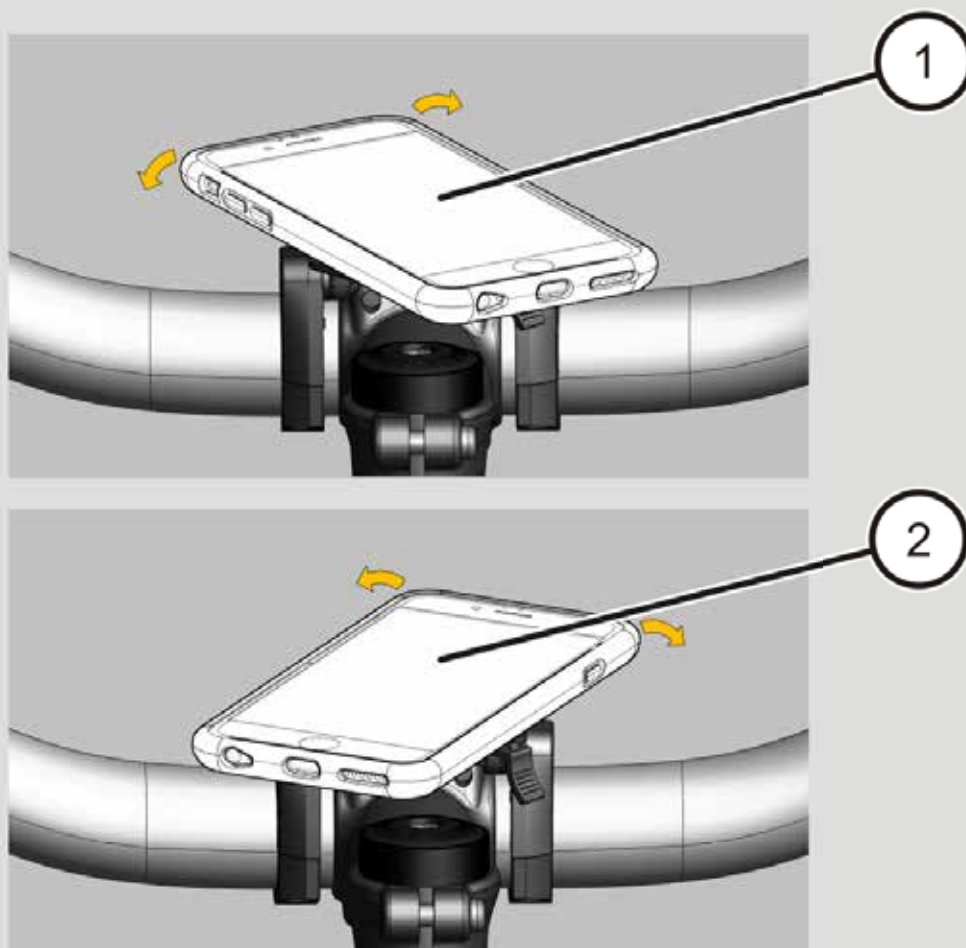

Mounting the COMPIT on the Handlebars of the Bicycle and Removing it

Your smartphone is vertically (3) or horizontally (4) mounted depending on how it is turned, The safety lever (5) is locked in place.

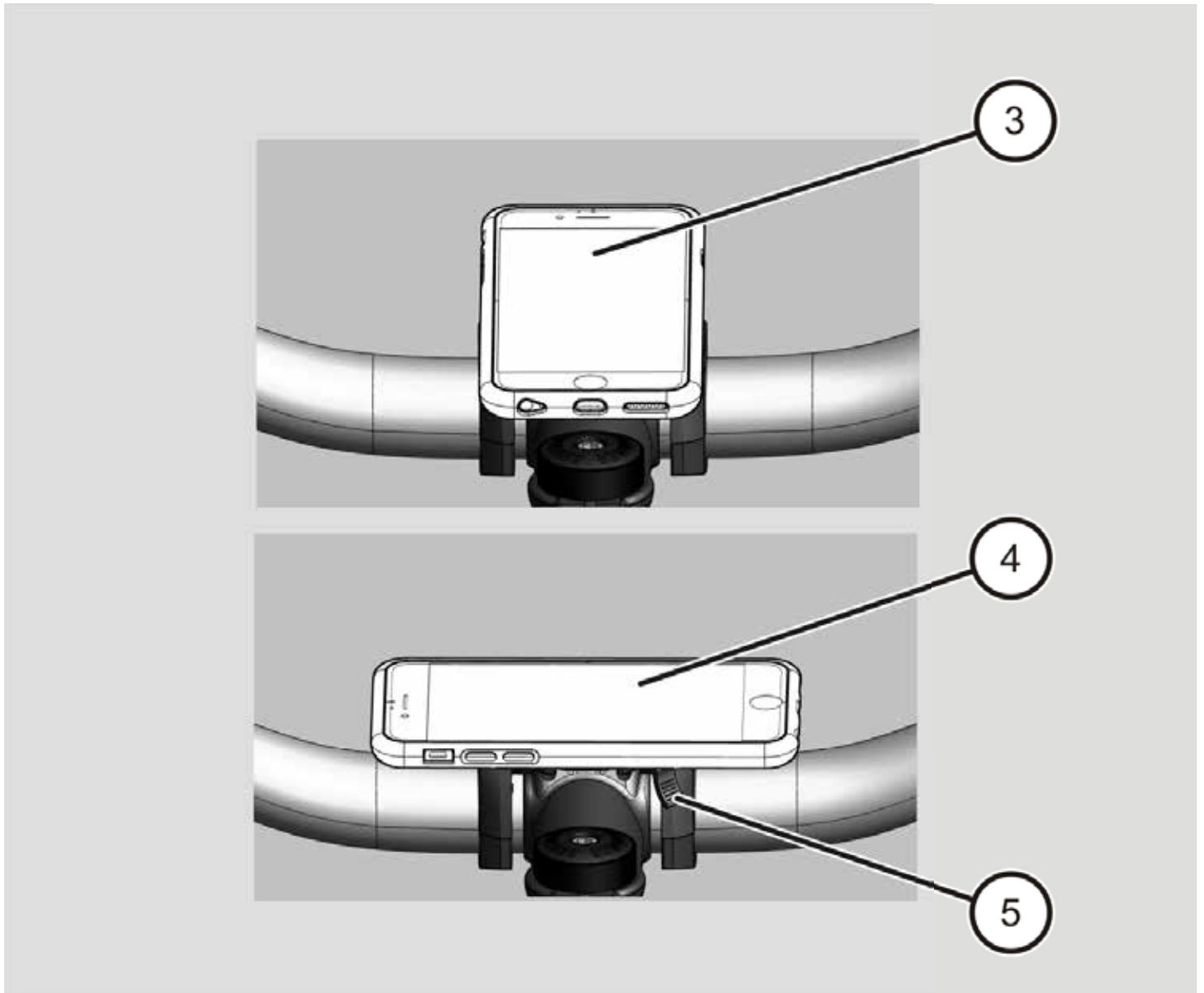

You can remove your smartphone from the COMPIT as follows:

- Push the safety lever (5) down.
- Remove your smartphone from the COMPIT by turning it off the docking station (approx. 45 degrees).

Adjusting the Inclination

You can bring your smartphone into the required position on the COMPIT by using the inclination adjustment. You can adjust the inclination as follows:

- Press the smartphone (1) on the COMPIT down or lift it up until you have reached the required position.
- Tighten the inclined screw (2) in order to fix the required inclination setting.

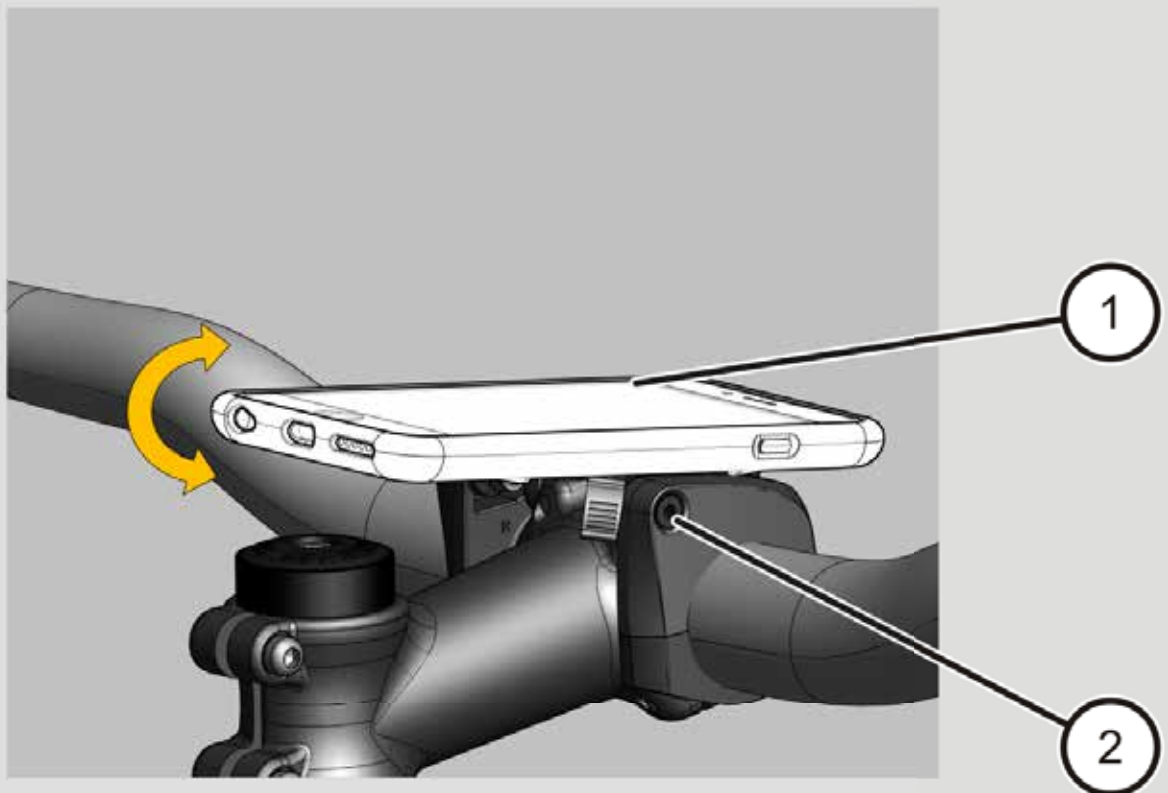

Charging the Smartphone via the +COM/UNIT

Cableless charging of the smartphone

Should you have a smartphone with a Qi charging function, you can charge it on the road via the +COM/UNIT without the need for a cable. You can do this as follows:

- Ensure that the +COM/UNIT has been adequately charged (min. 50%).
- Mount the +COM/UNIT on the COMPIT analogue with the smartphone, (please refer to page 30).
- Press the  in order to switch the +COM/UNIT on.

The bottom LED is illuminated blue and the LEDs for the battery indicator are illuminated orange. The +COM/UNIT is now switched on.

- Place your smartphone on the Qi docking station (as shown in 1 or 2) of the +COM/UNIT and turn it to the right or left (by approx. 45 degrees) above the Qi docking station until it audibly locks into place. The smartphone starts to charge automatically.

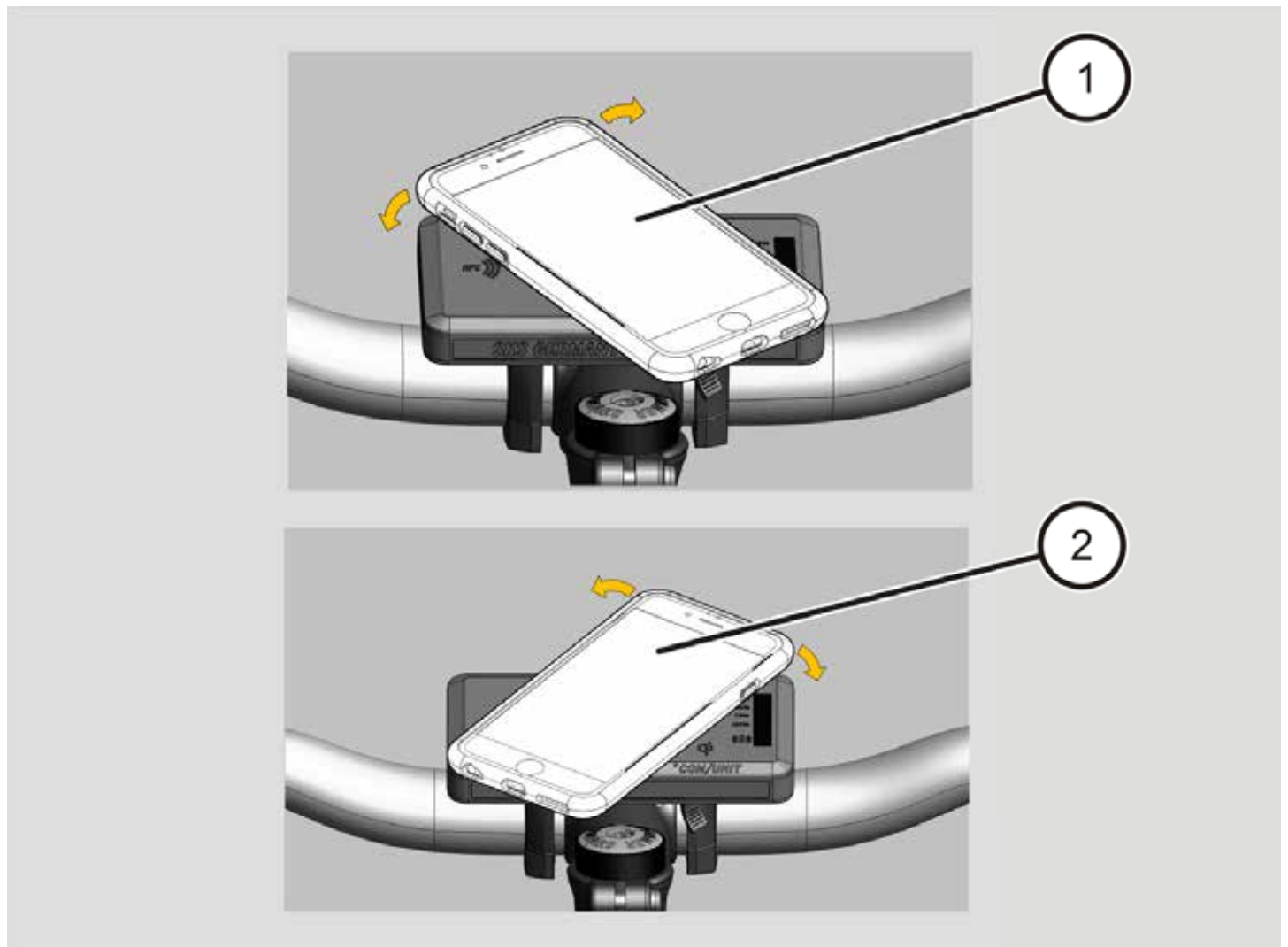

Charging the Smartphone via the +COM/UNIT

The smartphone is mounted vertically (3) or horizontally (4) depending on how it is turned.

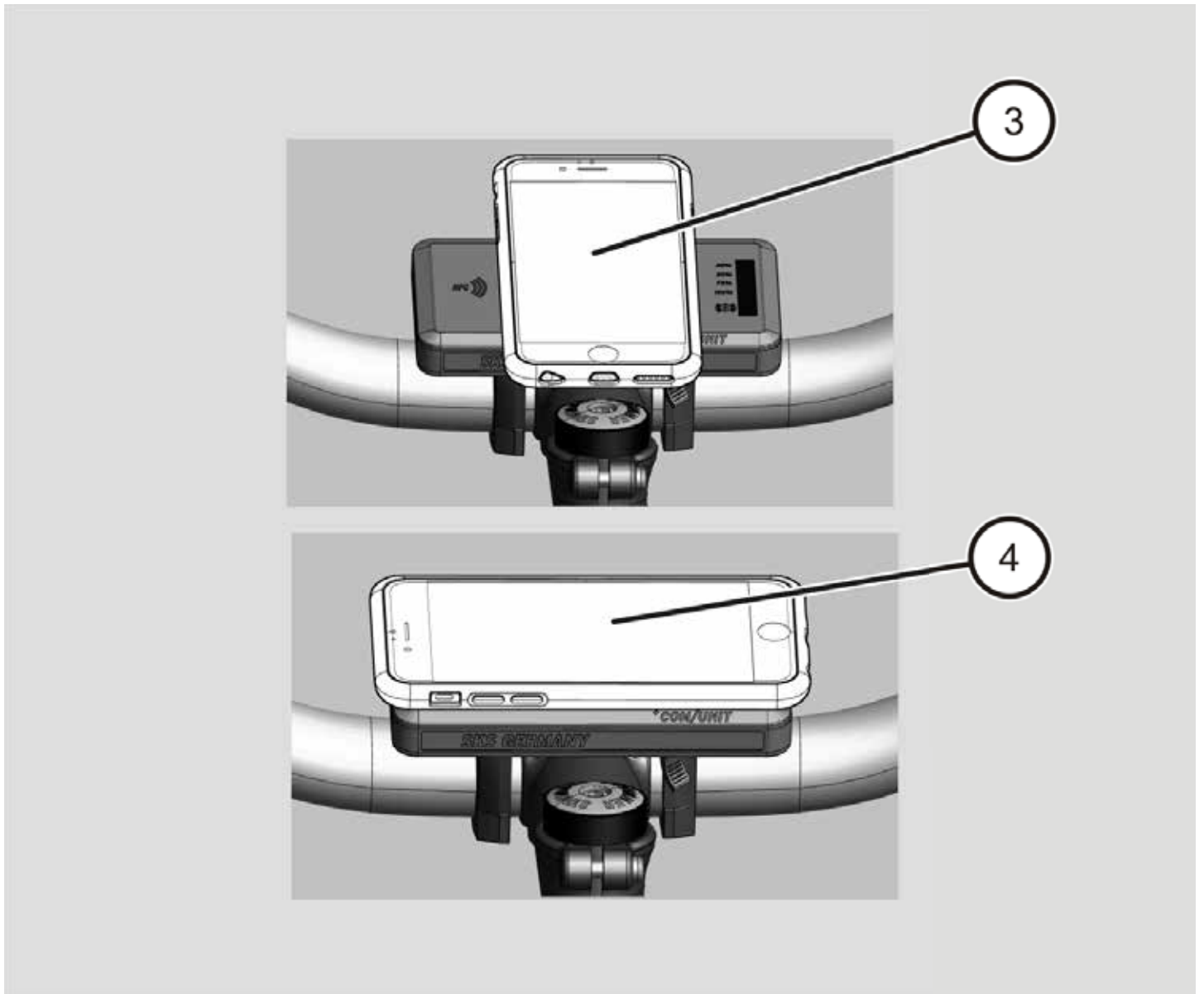

The bottom LED flashes blue. The smartphone charges.

- To terminate the charging process manually and switch the +COM/UNIT off without removing the smartphone from the +COM/UNIT, switch off by pressing the  button for approx. 2 seconds.
- ① The +COM/UNIT switches itself off automatically should a smartphone not be placed on it for charging after 30 seconds at the latest.

Charging the smartphone with a cable

Should you have a smartphone that does not have a Qi charging function, you can charge it via the +COM/UNIT using an optional USB cable as follows when you are on the road:

- Ensure that the +COM/UNIT has been adequately charged (min. 50 %).
- Connect the optional USB cable (2) to the output port of the +COM/UNIT (2).
- Now connect it to your smartphone (1).

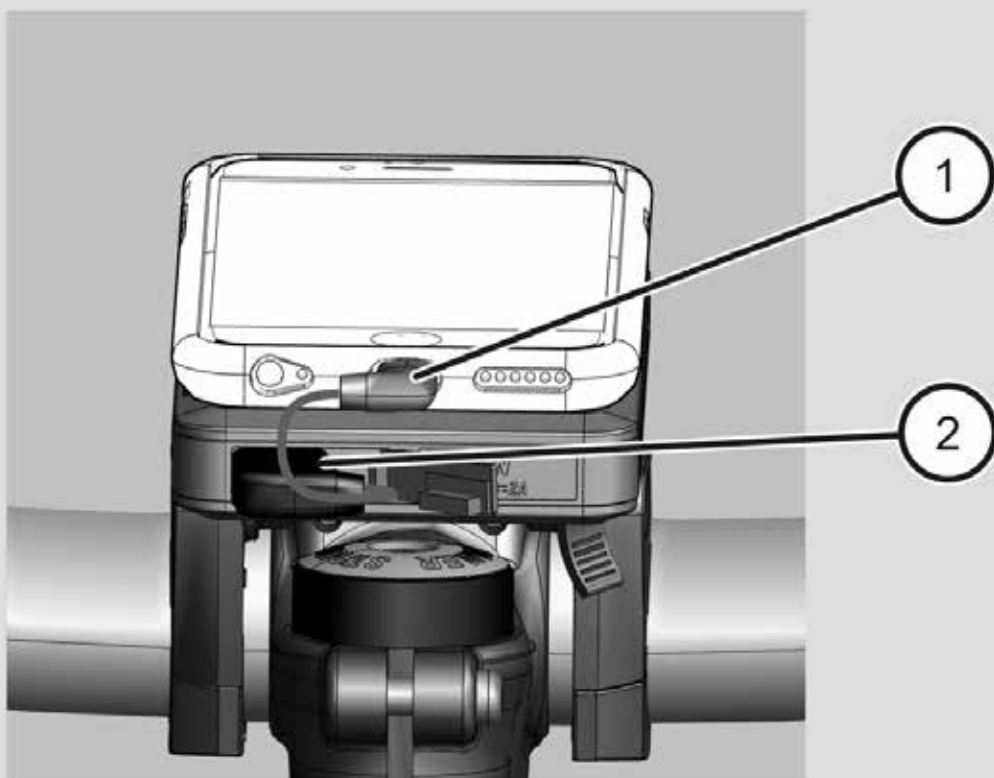

- To charge your smartphone, refer to the instructions in the section headed Charging the smartphone without a cable, please refer to page 33.

Carry out the following after you have charged your smartphone:

- Disconnect the USB cable from your smartphone and from the +COM/UNIT.
- Remove your smartphone from the +COM/UNIT by turning it over the Qi docking station (approx. 45 degrees).
- Press the safety lever and remove the +COM/UNIT analogue to the smartphone.
- Recharge the +COM/UNIT if necessary, please refer to page 37.

Using the NFC

The +COM/UNIT is equipped with an NFC chip (NEAR FIELD COMMUNICATION). The NFC chip that is integrated in the +COM/UNIT can be put to various uses.

The most diverse contents can be stored on the NFC chip it then being possible to read these out using an NFC-capable smartphone. The content can be a URL, a text or commands and applications that are generated using an app for the writing of NFC chips.

This enables numerous smartphone settings to be changed at the same time when scanning the NFC chip of the +COM/UNIT in addition to it being possible to automatically start apps such as the SKS MYBIKE app.

You can use the NFC (NEAR FIELD COMMUNICATION) as follows:

- Activate the NFC (NEAR FIELD COMMUNICATION) on your smartphone.
- Hold your smartphone close to the NFC chip of the +COM/UNIT (1-4 cm).

The content of the NFC chips is read out and the function that is programmed on the NFC chip is executed.

Charging the +COM/UNIT

You can charge the +COM/UNIT as follows:

- Insert the plug of the USB cable that is included in the scope of delivery in the USB input port (1) and connect it with a suitable charger.

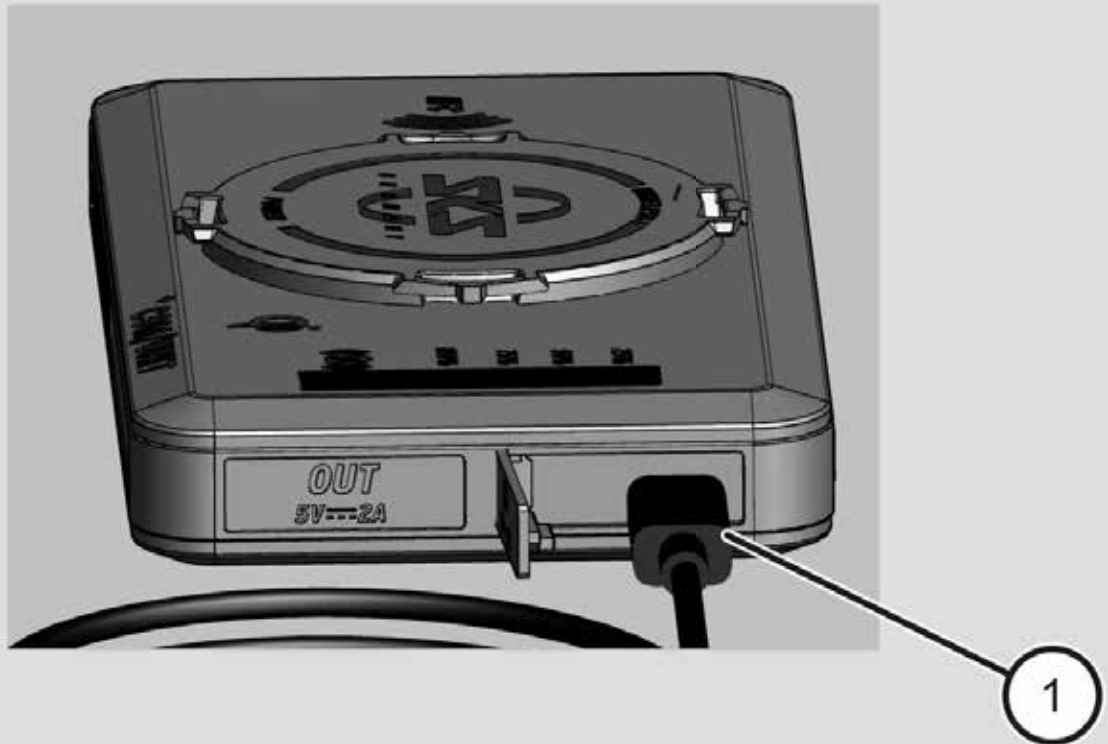

All four of the orange LEDs are illuminated if the +COM/UNIT battery is fully charged. The anticipated charging duration is approx. 6 hours (depending on the charger).

Troubleshooting

Sympton	Cause	Remedy
The blue LED on the +COM/UNIT is flashing fast.	Error when charging the smartphone	➤ Remove your smartphone from the +COM/UNIT and alter its position. When doing so ensure that your smartphone is positioned in the centre on the SKS logo.

Caring for the Product

Care for the product as follows:

- If necessary, clean the exterior of the product using a moistened cloth.

Accessories

Designation	Order number
Cover iPhone 6/7/8	11538
Cover iPhone 6+/7+/8+	11539
Cover iPhone X	11540
Cover SAMSUNG S7	11576
Cover SAMSUNG S8	11577
Cover SAMSUNG S9	11578
Cover HUAWEI P20 PRO+	11579

Designation	Order number
Cover adapter Dimensions: 60 x 60 x 4 mm	11541

Designation	Order number
Cable iPhone Lightning	11542
Cable Micro USB	11543
Cable Typ C	11544

Designation	Order number
COM/CAM Adapter	11545

Designation	Order number
COM/LIGHT	11582

Disposing of the Product

In Germany

- Sort the product packaging and dispose of it accordingly. Make use of the local possibilities for the collection of paper, cardboard and lightweight packaging.
- The product and the accessories are not to be disposed of in the household waste. You can obtain information on collection points that accept old products free of charge from your local authority.



Outside Germany

- Dispose of the product and the packaging conform with the provisions that have validity for the place of use.

Warranty Declaration

SKS metaplast Scheffer-Klute GmbH GERMANY provides a 2-year warranty as from the date of purchase in the scope of the legal provisions for all parts that are included in the scope of delivery (proof with the purchase receipt). Wearing parts are excluded - this especially being the +COM/UNIT battery unit. This is covered by a 6 months SKS GERMANY warranty. An incorrect handling or wrong use excludes a liability for defects.

Returns to Customer Service

Please take the following action as soon as you detect damage on the product:

➤ Please return the product to the following address in the original packaging and enclose a precise description of the damage:

SKS metaplast Scheffer-Klute GmbH
Zur Huberstushalle 4
59846 Sundern, Germany
Tel.: +49-2933-8310

