

1. Prepare the COMPIT for the COM/PAD All COMPIT versions (except COMPIT/ANYWHERE)

1. Loosen and remove the levelling screws on both sides
2. Remove the docking station

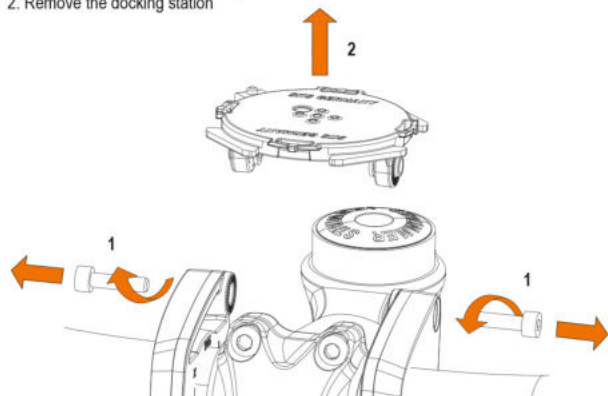

4. Insert the sealing ring again. Attach the connection plate with the cable and secure it with screws. Do not exceed the 0.15 Nm tightening torque of the screws.

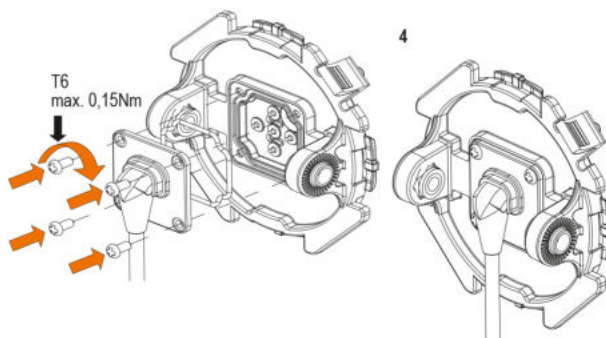

- 3-4. Loosen and remove the screws (T6). Remove and discard the dummy cover.

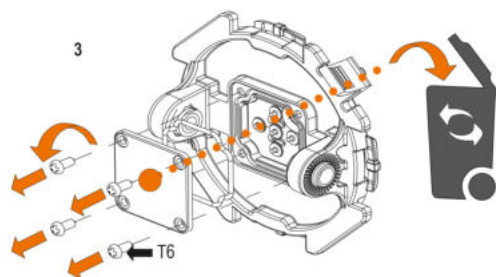

5. Insert the docking station between the retaining clamps.
6. Insert the levelling screws and tighten them slightly. Adjust the angle of the docking station. Tighten the levelling screws.

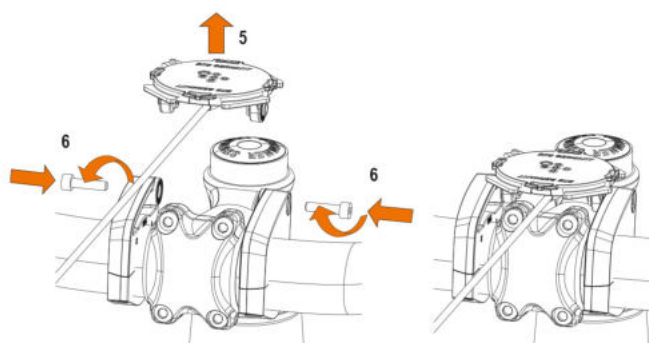

2. Connect the COMPIT to the e-bike

For e-bikes with a 12 V-36 V lighting system or power supply

Route the COMPIT connection cable to the motor, ensuring that the cable is routed cleanly along the cable routing specific to the bicycle model. Connect the COMPIT connection cable to the cable of the lighting system with waterproof terminals at a suitable point. Alternatively, solder connections can also be used. Motor (connection cable is not supplied)

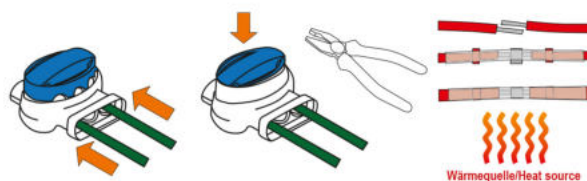

BOSCH Gen. 2,3 und 4
Active Line/Performance Line/CX
Front light connection

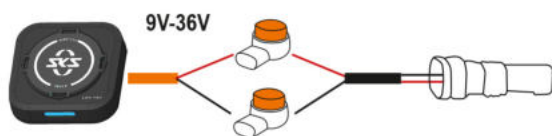

Yamaha PB-X
Front light connection 12 V

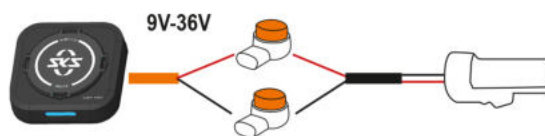

BOSCH Gen. 4
Light connection or 12 V aux.

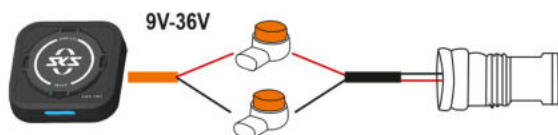

BAFANG M620
7015-BS-2 12V / 12W

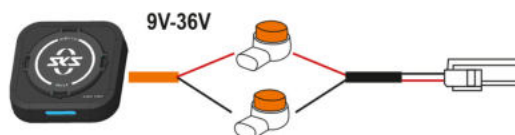

Fazua
JST VSLE 03R connector / 12 V

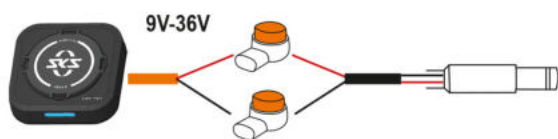

Shimano / screw terminals
Light connection 12 V

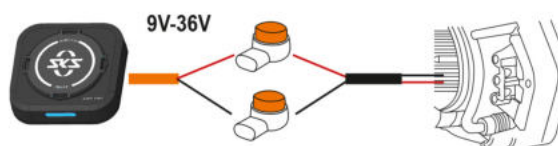

Brose S
Front light connection 12 V

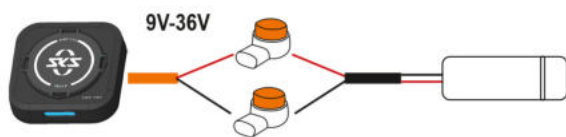

Panasonic
Light connection max. 36 V

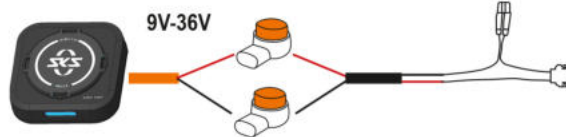

3. Attach the COM/PAD

Place the COM/PAD on the COMPIT and turn it (about 45°) either to the right or left above the docking station until you hear it click into place.

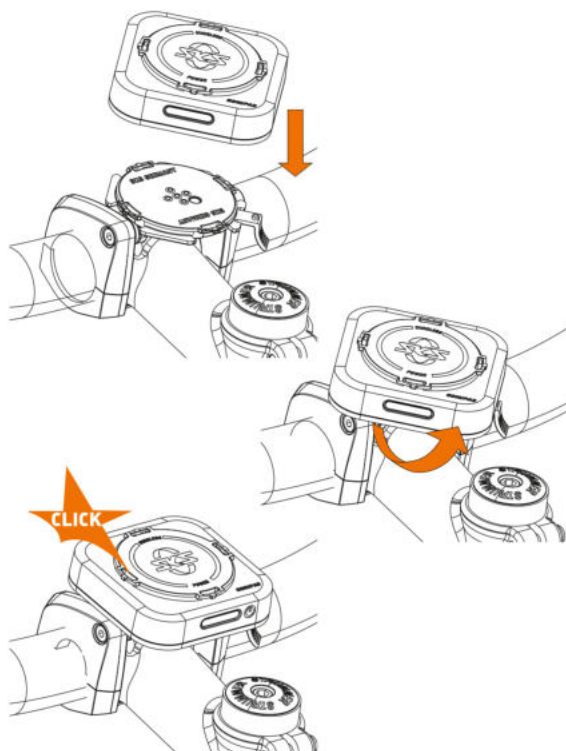

ATTENTION

COMPIT-clamps must be installed parallel to each other.

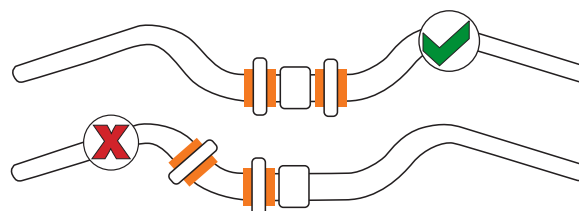

OPTIONAL!

Screw in the anti-theft lock

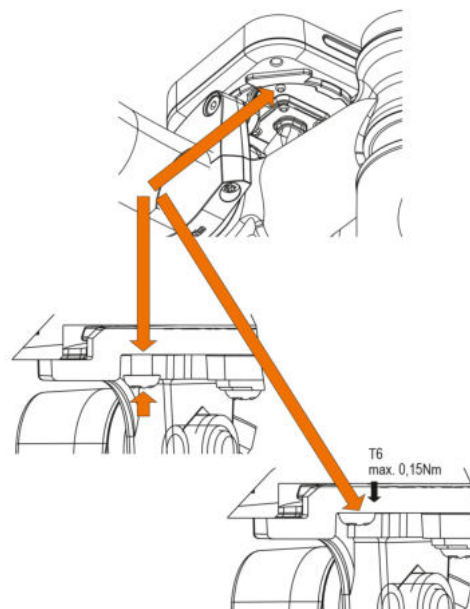

4. Activate the COM/PAD

Switch on the e-bike

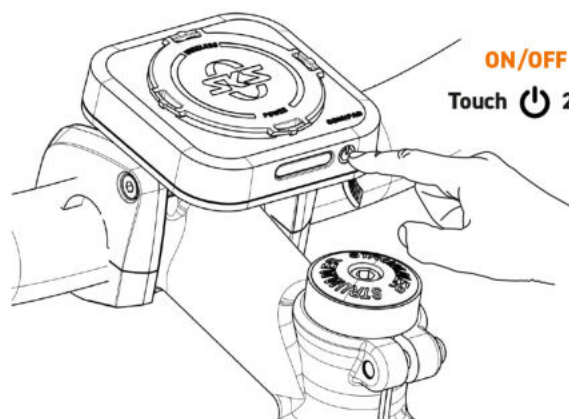
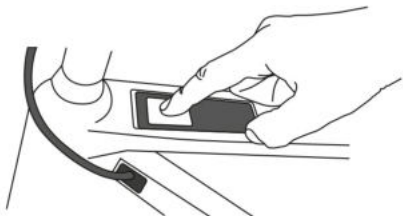

ON/OFF
Touch 2 sec.

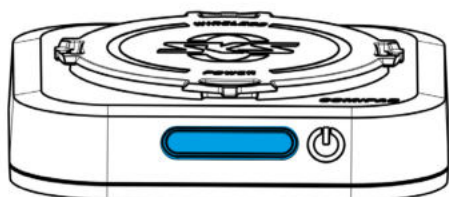

(((⚡))) ON

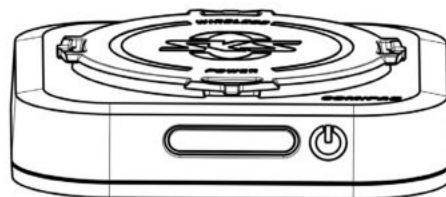

(((⚡))) OFF



USB C-PD OFF

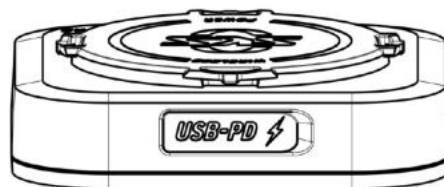

USB C-PD ON

5. Charge the mobile device wirelessly

- 1 Switch on the COM/PAD. LED indicator lights up blue
- 2 Attach the mobile device and lock it by turning it
- 3 Mobile device is charged and LED indicator flashes blue.

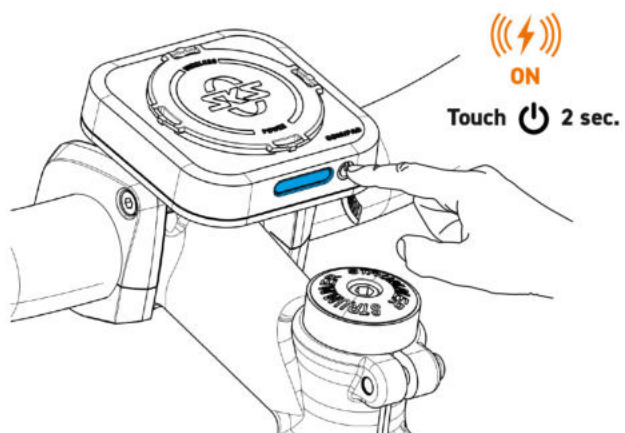

(((⚡))) ON
Touch 2 sec.

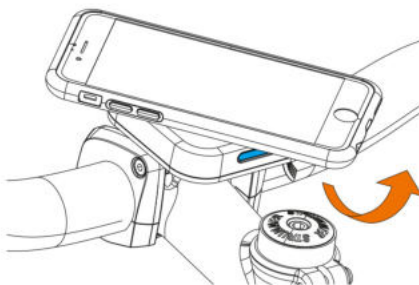
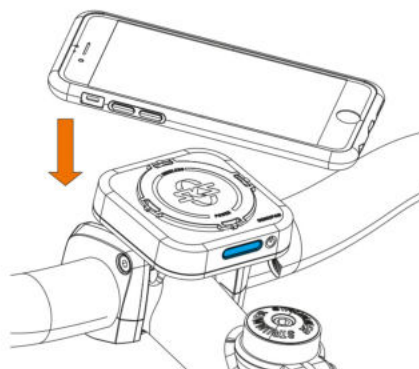

6. Charge the mobile device with cable

- 1 Switch on the COM/PAD USB C PD output. LED indicator is off!
 - 2 Connect the cable (not supplied) to the COM/PAD.
 - 3 Attach the mobile device and lock it by turning it
 - 4 Connect the cable (not supplied) to the mobile device.
- The mobile device is charging.

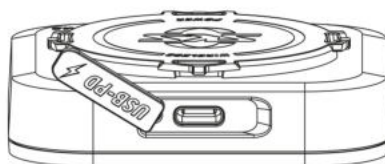

USB C-PD ON



7. Charge your mobile device wirelessly via USB C

1. Connect the cable (not supplied) between the COM/PAD and the power source.
(5V/2A, 9V/1.67A, 12V/1.5A) The LED indicator lights up blue.
2. Place the mobile device and lock it by turning it.
3. The mobile device is now charging and the LED indicator flashes blue.

5V/2A
9V/1.67A
12V/1.5A

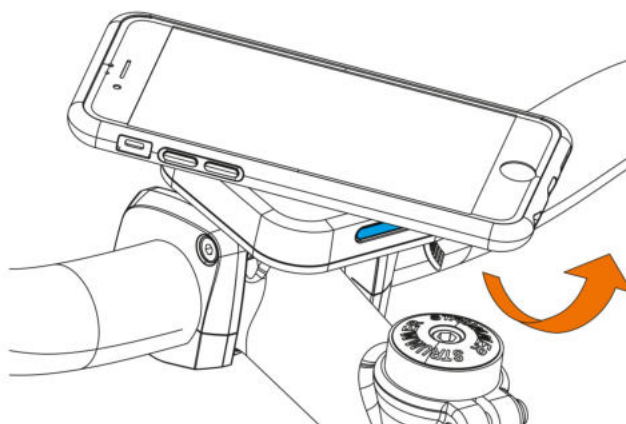
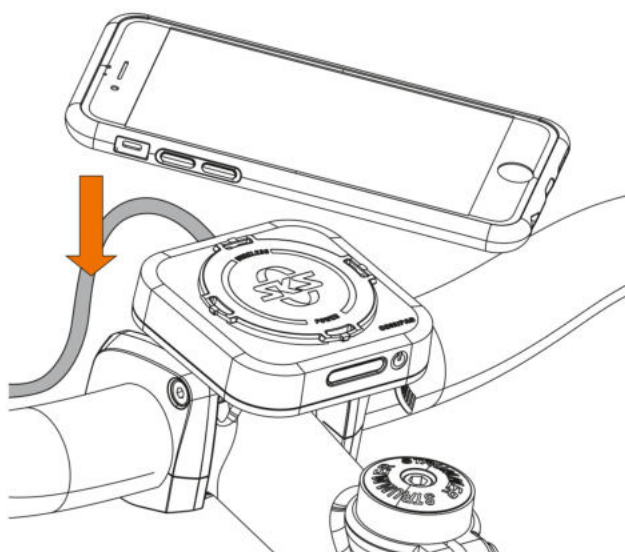
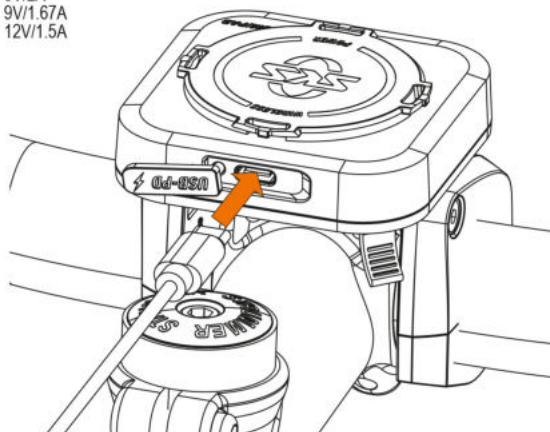



Technical data

| | |
|------------------------------|--------------------------------------|
| Dimensions: | 72 x 72 x 19 mm |
| Input EXT: | 9-36V |
| Output USB-C: | 5V/2A - 9V/1,3A - 12V/1.0A (12W max) |
| Output Wireless: | 5W/7.5W/10W (max) |
| Input: | USB-C 5V/2A, 9V/1,67A, 12V/1.5A |
| Output Wireless: | 5W/7.5W/10W/15W (max) |
| Wireless efficiency: | >70% |
| Operating frequency: | 110KHz-205KHz |
| Maximum transmittable power: | -7. 26dBuA/m |
| Protection rating: | IP54 |



SAFETY INSTRUCTIONS

The Operating Instructions are a constituent part of the product and includes important safety instructions for the correct use. The non-adherence to these safety instructions can result in damage, severe and/or mortal injuries. Detailed Instructions for Use that provides information on the assembly and use of the product can be downloaded from here:

QR-LINK: to the title of the Operating Instructions
WEBSITE: [sks-germany.com](https://www.sks-germany.com)

SIMPLIFIED EU DECLARATION OF CONFORMITY

The simplified EU declaration of conformity according to Article 10 (9) is indicated as follows: SKS GERMANY hereby declares that the COM/PAD radio system mentioned in these instructions complies with regulation 2014/53 / EU. The full text of the EU declaration of conformity is available on the following website:

www.sks-germany.com/service/downloads

