

**CHAINBOW\_E (Bosch 3. Generation)**

For installation crank and bottom bracket have to be disassembled. Special tooling equipment required. Please contact your dealer.

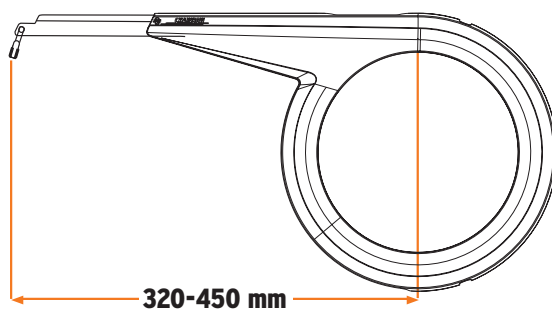

**Example: CHAINBOW max. 44**

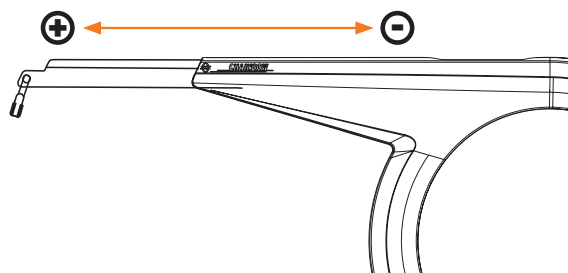
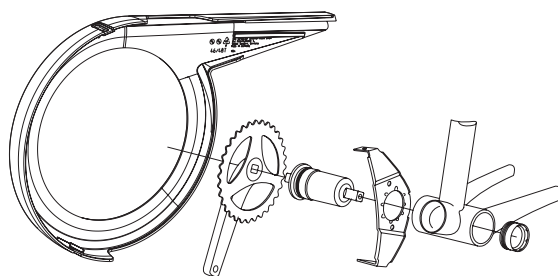

**ATTENTION! Please check compatibility of crank.**

**EN. CHAINBOARD**

Aluminium composite chainguard. Extremely light and robust. Resistant to corrosion. Design compatible to the SKS-fenders range.