

Parts

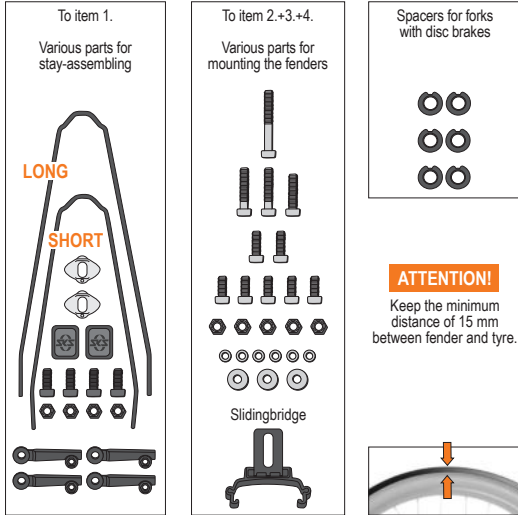

1. Stay-assembly front + rear

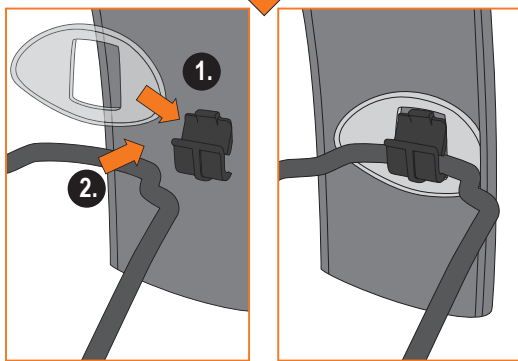
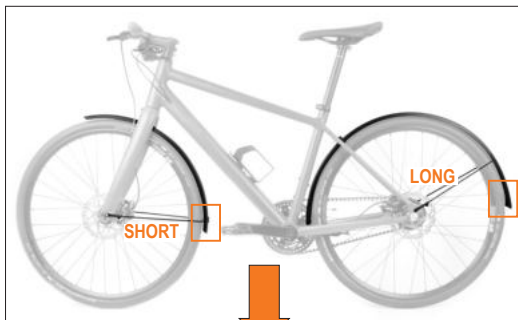
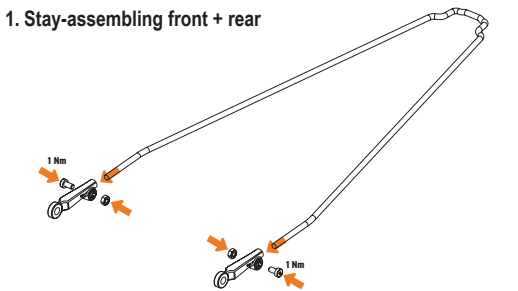

2. Frame mounting front

2.1 Brake-fitting front

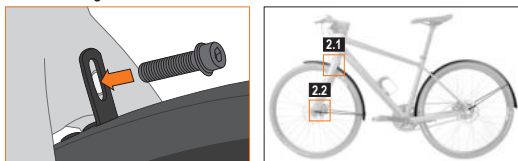

2.2 Stay attachment front incl. lengths adjustments of the stays

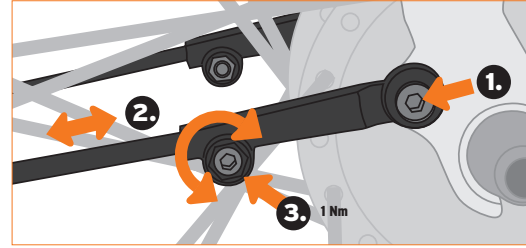

3. Frame mounting rear

3.1 Remove the rear wheel

3.2 Assembling of sliding bridge 90° degree angle

3.2.1 Screw the sliding bridge

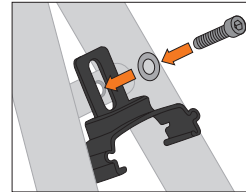

3.2.2 Clip the fender on the sliding bridge

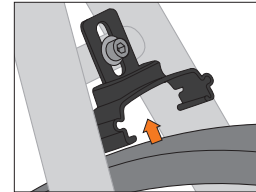

3.3 Assembling of sliding bridge 0° degree angle

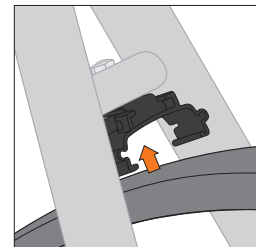
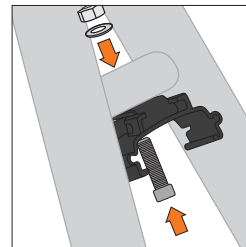

4. Assembling at the bottom bracket

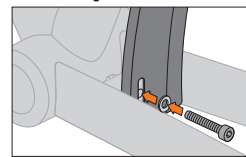

5. Remount the rear wheel

6. Rear stay assembling

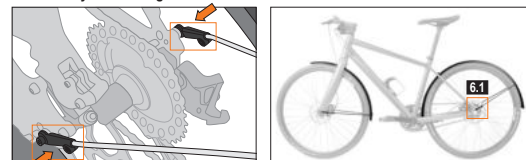

6.1 Stay attachment rear incl. lengths adjustments of the stays

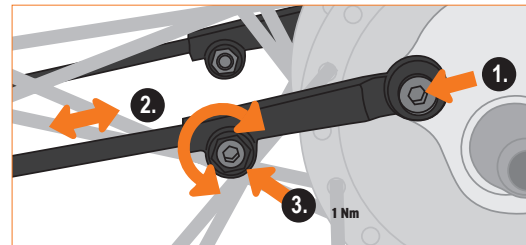

ATTENTION! Mounting of spacers for frames with disc brakes

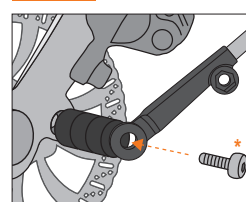

* Screw is not included in the scope of delivery